



**DRILL
MATIC**
by **EUROMA**GROUP

EN

DRILLING UNITS / BOHREINHEITEN
TAPPING UNITS / GEWINDESCHNEIDEEINHEITEN
MACHINING SPINDLES / SPINDELEINHEITEN
SLIDE UNITS / SCHLITTEN
ROTARY INDEXING TABLES / RUNDSCHALTTISCHE

DE





WE
DIALOGUE,
DESIGN
AND **BUILD**
TOGETHER

Electro-pneumatic drilling units / Elektropneumatische Bohreinheiten **6**

DXP10.75/150	7
DXP18.100 / 150	8
DXP24.120	9
DXE10.60/130 <i>CNC Machining units</i> / CNC Bearbeitungseinheiten	10
DXE16.90/130 <i>CNC Machining units</i> / CNC Bearbeitungseinheiten	11
DXE23.115 <i>CNC Machining units</i> / CNC Bearbeitungseinheiten	12
DXE24.120 <i>CNC Machining units</i> / CNC Bearbeitungseinheiten	13
DXE42.160 <i>CNC Machining units</i> / CNC Bearbeitungseinheiten	14

Tapping units / Gewindeschneideinheiten **15**

TX12.50/100	16
TX20.80/100	17
TX28.120	18
TX42.80/130	19
Lead screw / Leitpatrone	20
DTX12.75/150 <i>Units for combined drill - tapping</i> / Bohr-und Gewindeschneideinheiten	21
DTX16.100/150 <i>Units for combined drill - tapping</i> / Bohr-und Gewindeschneideinheiten	22

Machining spindles / Spindeleinheiten **23**

DX22	24
DX28	25
DX38	26
DX38L (S)	27
DX58	28
DX88	29

Slide units / Schlitteneinheiten **30**

EX28	31
EX32	32
EX38	33
EX58	34
HX38	35

Rotary indexing tables / Rundschalttische **36**

TA220 <i>With two tapered pins / Mit zwei sperrbolzen</i>	37
TA220 <i>With hirth gears / Mit hirth planverzahnun</i>	38
TA326	39
TA600	40
TA700	41

Accessories / Zubehör **42**

<i>Supports and brackets / Standardzubehör</i>	43
--	----

Multiple heads / Mehrspindelköpfe **48**

<i>Multiple heads / Mehrspindelköpfe</i>	49
--	----

A blue and black electro-pneumatic drilling unit is shown in the background. The unit has a blue motor housing and a black sliding guide. In the foreground, a close-up of the drilling unit's spindle and a gold-colored drill bit is visible.

*Electro-pneumatic
drilling units*
Elektropneumatische
Bohreinheiten



FEATURES

- *Sliding guide with grooved profile*
 - *Inductive sensores*
- *Speed range up to 18 possibilities*
 - *New hydraulick brake*

EIGENSCHAFTEN

- Schiebeführung mit Rillenprofil
 - Induktive Sensoren
- Geschwindigkeitsbereich mit bis zu 18 Möglichkeiten
 - Neue hydraulische Bremse

Electro-pneumatic drilling units Elektropneumatische Bohreinheiten

	THRUST VORSCHUBKRAFT	1350 N
	WEIGHT GEWICHT	16-21 Kg

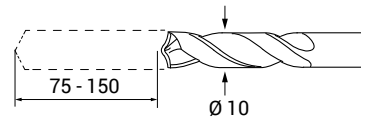

DRILLING CAPACITY IN STEEL R=60
BOHRLEISTUNG IN STAHL R=60

Ø 10

STROKE
HUB

75 mm
150 mm

TOOLHOLDER
WERKZEUGAUFNAHME

A = B12 DIN 238
F = DIN 55058 Ø 16
L = ER20

SPINDLE RPM (50HZ) / SPINDEL DREHZAHL

E	400	6P	CHAIN KETTE
F	500		
G	600		
H	800	6P	TIMING BELT ZAHNRIEMEN
I	1000		
J	1200		
K	1500		
L	1800	4P	
M	2000		POLY - V BELT POLY - V RIEMEN
N	2400		
O	3000	2P	
P	3600		
Q	4000		
R	4500		
S	5400		
T	6400	2P	
U	7500		
V	8400		

DXP 10 /.. /.. /.. /.. /..

MOTOR / MOTOR

203	=	80	-	0,75 kW	2P
403	=	80	-	0,55 kW	4P
604	=	80	-	0,55 kW	6P

Max frame 80 / Max Größe 80

HYDROCHECK / HYDRAULIKBREMSE

HF50 = STROKE/ HUB 50 mm
HF75 = STROKE/ HUB mm
HF100 = STROKE/ HUB mm

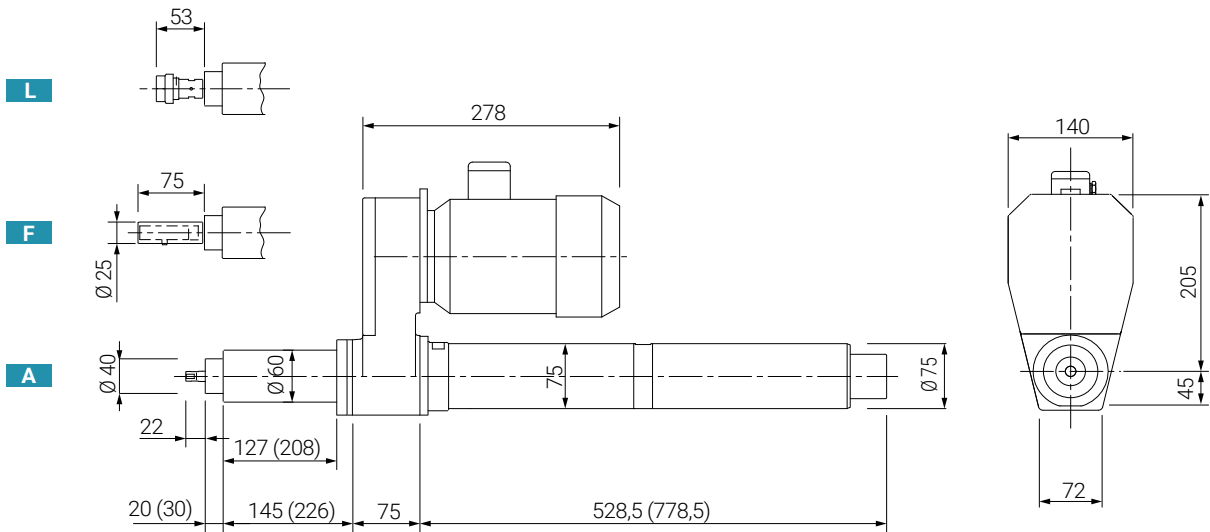

Dimension () are for the 150 mm stroke unit / (Quoten) = Einheit mit Hub 150

ACCESSORIES

(Page 42)

- Multi spindle heads
- Pneumatic peck feed device
- For brackets see 3D pictures



ZUBEHÖR

(Seite 42)

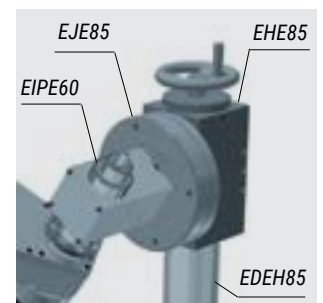
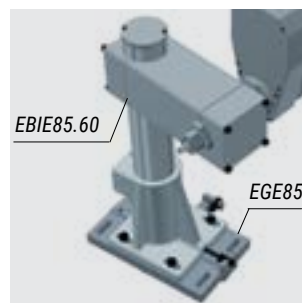
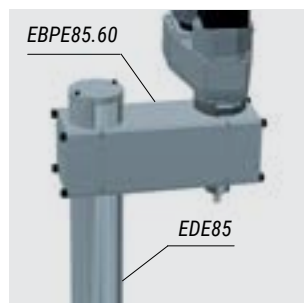
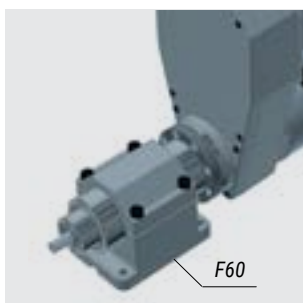
- Mehrspindelköpfe
- Pneumatische Entspäneinrichtung
- Zubehör siehe 3D Abbildung



Electro-pneumatic drilling units Elektropneumatische Bohreinheiten

	THRUST VORSCHUBKRAFT	4000 N
	WEIGHT GEWICHT	45-49 Kg

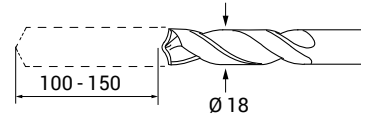

DRILLING CAPACITY IN STEEL R=60
BOHRLEISTUNG IN STAHL R=60

Ø 18

STROKE
HUB

100 mm
150 mm

TOOLHOLDER
WERKZEUGAUFNAHME

B = B18 DIN 238 H = DIN 55058 Ø 28
D1 = MORSE 2 N = ER32

SPINDLE RPM (50HZ) / SPINDEL DREHZAHL

A	160	R6P	CHAIN WITH REDUCER GETRIEBEKETTE
B	200		
C	250		
D	300		
E	400	6P	CHAIN KETTE
F	500		
G	600	4P	TIMING BELT ZAHNRIEMEN
H	800		
I	1000		
J	1200		
K	1500	2P	
L	1800		
M	2000	2P	POLY-V BELT POLY-V RIEMEN
N	2400		
O	3000		
P	3600		
Q	4000		
R	4500		

DXP 18 /.. /.. /.. /.. /..

MOTOR / MOTOR

205	=	90	-	1,50 kW	2P
406	=	90	-	1,50 kW	4P
606	=	90	-	1,10 kW	6P

Max frame 112 / Max Größe 112

HYDROCHECK / HYDRAULIKBREMSE

HF50 = STROKE/ HUB 50 mm
HF75 = STROKE/ HUB 75 mm
HF100 = STROKE/ HUB 100 mm

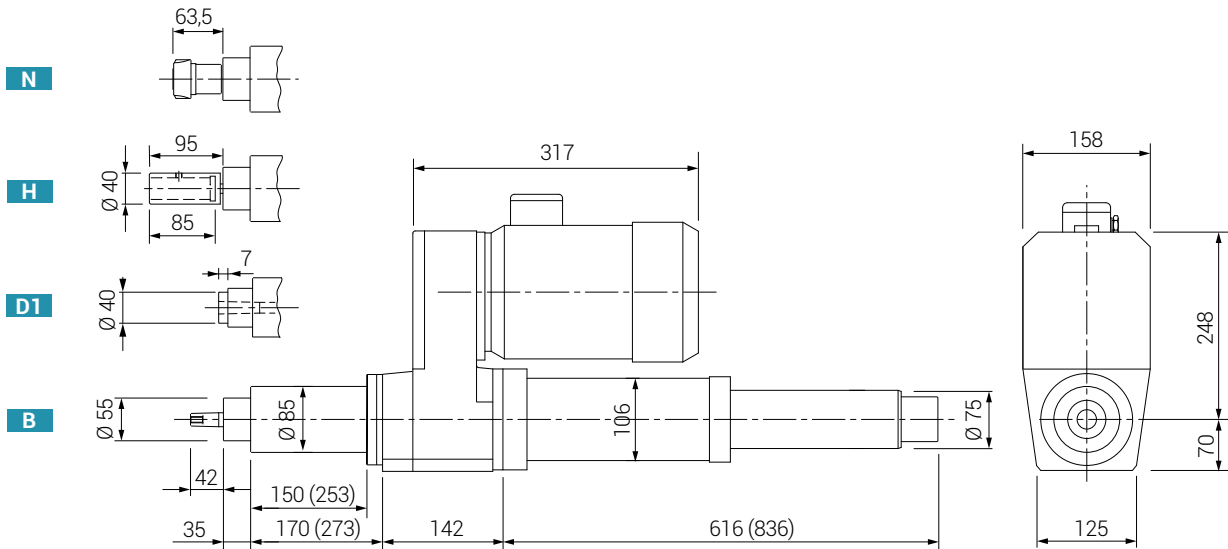

Dimension () are for the 150 mm stroke unit / (Quoten) = Einheit mit Hub 150

ACCESSORIES

(Page 42)

- Multi spindle heads
- Pneumatic peck feed device
- For brackets see 3D pictures



ZUBEHÖR

(Seite 42)

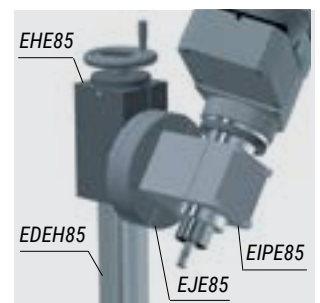
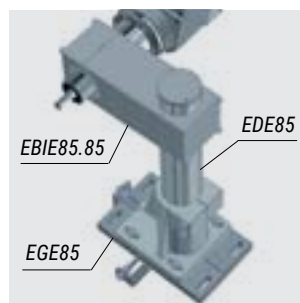
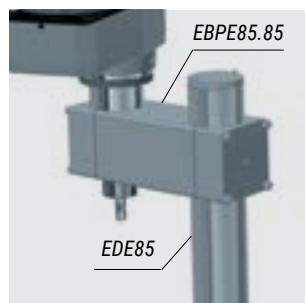
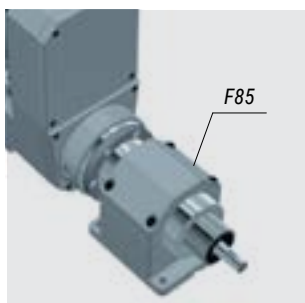
- Mehrspindelköpfe
- Pneumatische Entspäneinrichtung
- Zubehör siehe 3D Abbildung



Electro-pneumatic drilling units Elektropneumatische Bohreinheiten

	THRUST VORSCHUBKRAFT	5500 N
	WEIGHT GEWICHT	85 Kg

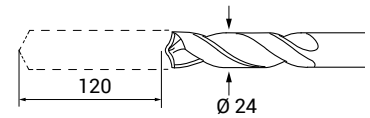

DRILLING CAPACITY IN STEEL R=60
BOHRLEISTUNG IN STAHL R=60

Ø 24

STROKE
HUB

120 mm

TOOLHOLDER
WERKZEUGAUFNAHME

H1 = DIN 55058 Ø 28
S = ISO 30

SPINDLE RPM (50HZ) / SPINDEL DREHZAHL

D	300	R6P	CHAIN WITH REDUCER GETRIEBEKETTE
E	400		CHAIN KETTE
F	500	6P	
G	600		
H	800	6P	
I	1000		
J	1200		
K	1500	4P	TIMING BELT ZAHNRIEMEN
L	1800		
M	2000		
N	2400		
O	3000	2P	
P	3600		
Q	4000		

DXP 24 /120 /.. /.. /.. /..

MOTOR / MOTOR

207	=	100	-	3 kW	2P
407	=	100	-	2,2 kW	4P
609	=	112	-	2,2 kW	6P

Max frame 112 / Max Größe 112

HYDROCHECK / HYDRAULIKBREMSE

HF100 = STROKE/ HUB 100 mm

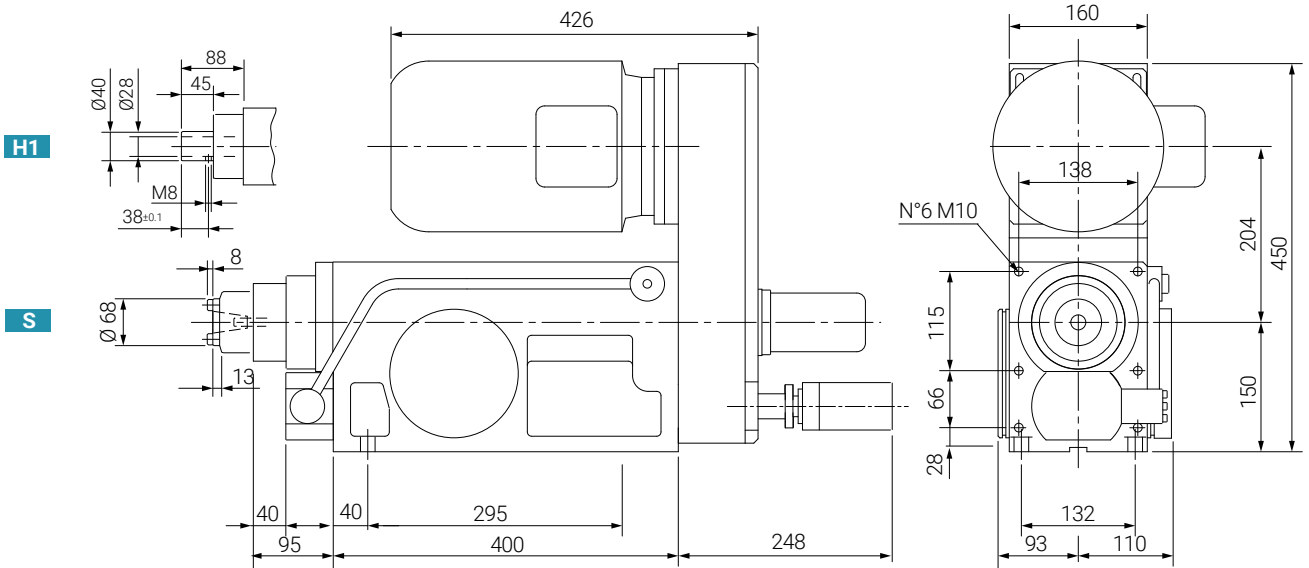



ACCESSORIES

- Supported by a set of taper roller bearings
- Multi spindle heads
- Pneumatic peck feed device

ZUBEHÖR

- Kegelrollenlager
- Mehrspindelköpfe
- Pneumatische Entspäneinrichtung

CNC Machining units CNC Bearbeitungseinheiten

	THRUST VORSCHUBKRAFT	1500 N
	WEIGHT GEWICHT	20 - 30 Kg

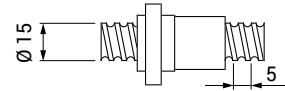

CAPACITY IN STEEL R=60
LEISTUNG IN STAHL R=60

Ø 10 / M12

STROKE
HUB

60 mm
130 mm

TOOLHOLDER
WERKZEUGAUFNAHME

A = B12 DIN 238
F = DIN 55058 Ø 16
L = ER20

SPINDLE RPM (50HZ) / SPINDEL DREHZAHL

E	400		CHAIN KETTE
F	500	6P	
G	600		
H	800	6P	TIMING BELT ZAHNRIEMEN
I	1000		
J	1200		
K	1500		
L	1800	4P	
M	2000		POLY - V BELT POLY - V RIEMEN
N	2400		
O	3000	2P	
P	3600		
Q	4000		
R	4500		
S	5400		
T	6400	2P	
U	7500		
V	8400		

DXE 10 /.. /.. /.. /..

MOTOR / MOTOR

203	=	80	-	0,75 kW	2P
403	=	80	-	0,55 kW	4P
604	=	80	-	0,55 kW	6P

Max frame 80 / Max Größe 80

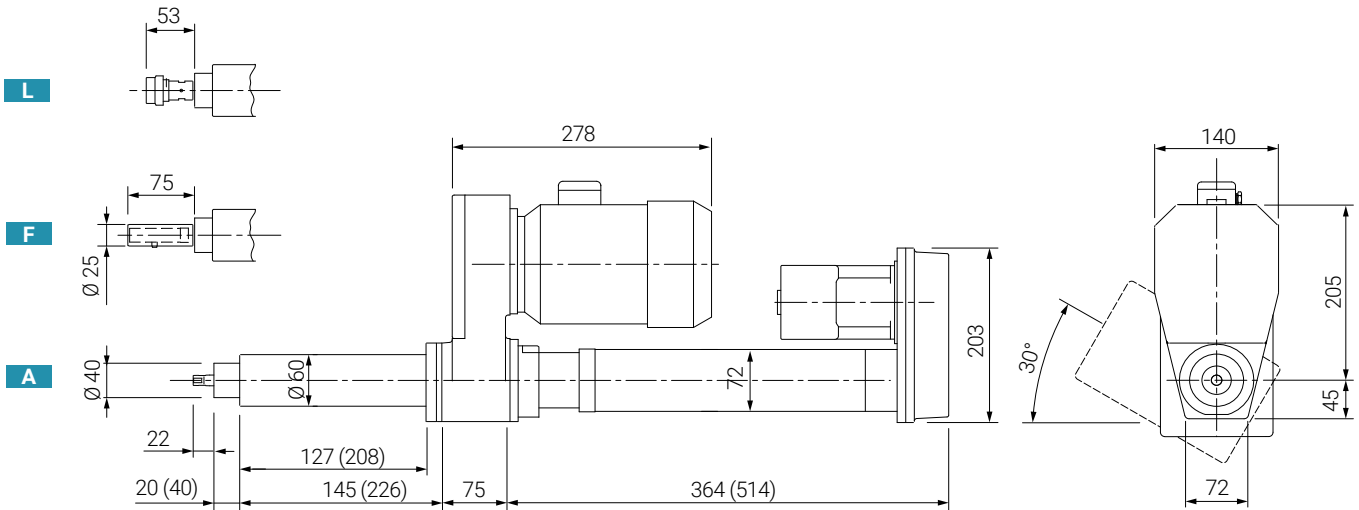

Dimension () are for the 130 mm stroke unit / (Quoten) = Einheit mit Hub 130

ACCESSORIES

(Page 42)

- Multi spindle heads
- Provision for brushless motor
- Provision for spindle motor
- For brackets see 3D pictures



ZUBEHÖR

(Seite 42)

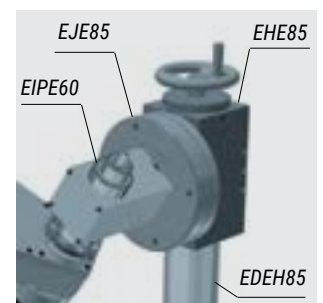
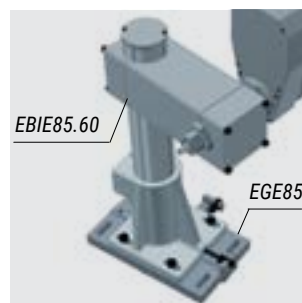
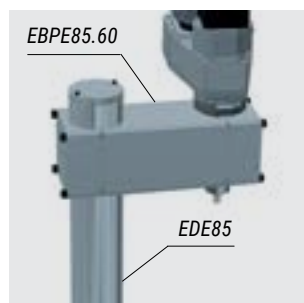
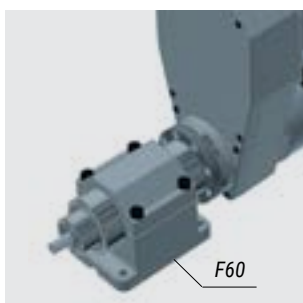
- Mehrspindelköpfe
- Vorbereitung für Servomotor
- Vorbereitung für Spindel
- Zubehör siehe 3D Abbildung



CNC Machining units CNC Bearbeitungseinheiten

	THRUST VORSCHUBKRAFT	5000 N
	WEIGHT GEWICHT	25 - 38 Kg

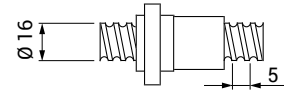

CAPACITY IN STEEL R=60 LEISTUNG IN STAHL R=60 Ø 16 / M20	STROKE HUB 90 mm 130 mm	TOOLHOLDER WERKZEUGAUFNAHME B = B18 DIN 238 H = DIN 55058 Ø 28 D1 = MORSE 2 N = ER32	SPINDLE RPM (50HZ) / SPINDELDREHZAHL <table border="1"> <tr><td>A</td><td>160</td><td></td></tr> <tr><td>B</td><td>200</td><td rowspan="4">R6P CHAIN WITH REDUCER GETRIEBEKETTE</td></tr> <tr><td>C</td><td>250</td></tr> <tr><td>D</td><td>300</td></tr> <tr><td>E</td><td>400</td></tr> <tr><td>F</td><td>500</td><td rowspan="2">6P CHAIN KETTE</td></tr> <tr><td>G</td><td>600</td></tr> <tr><td>H</td><td>800</td><td rowspan="4">6P TIMING BELT ZAHNRIEMEN</td></tr> <tr><td>I</td><td>1000</td></tr> <tr><td>J</td><td>1200</td></tr> <tr><td>K</td><td>1500</td></tr> <tr><td>L</td><td>1800</td><td rowspan="2">4P</td></tr> <tr><td>M</td><td>2000</td></tr> <tr><td>N</td><td>2400</td><td rowspan="3">2P</td></tr> <tr><td>O</td><td>3000</td></tr> <tr><td>P</td><td>3600</td></tr> <tr><td>Q</td><td>4000</td><td rowspan="2">2P</td></tr> <tr><td>R</td><td>4500</td></tr> <tr><td colspan="2"></td><td>POLY - V BELT POLY - V RIEMEN</td></tr> </table>	A	160		B	200	R6P CHAIN WITH REDUCER GETRIEBEKETTE	C	250	D	300	E	400	F	500	6P CHAIN KETTE	G	600	H	800	6P TIMING BELT ZAHNRIEMEN	I	1000	J	1200	K	1500	L	1800	4P	M	2000	N	2400	2P	O	3000	P	3600	Q	4000	2P	R	4500			POLY - V BELT POLY - V RIEMEN
A	160																																																
B	200	R6P CHAIN WITH REDUCER GETRIEBEKETTE																																															
C	250																																																
D	300																																																
E	400																																																
F	500	6P CHAIN KETTE																																															
G	600																																																
H	800	6P TIMING BELT ZAHNRIEMEN																																															
I	1000																																																
J	1200																																																
K	1500																																																
L	1800	4P																																															
M	2000																																																
N	2400	2P																																															
O	3000																																																
P	3600																																																
Q	4000	2P																																															
R	4500																																																
		POLY - V BELT POLY - V RIEMEN																																															

DXE 16 /.. /.. /.. /..

MOTOR / MOTOR			
205	=	90	- 1,50 kW 2P
406	=	90	- 1,50 kW 4P
606	=	90	- 1,10 kW 6P

Max frame 112 / Max Größe 112

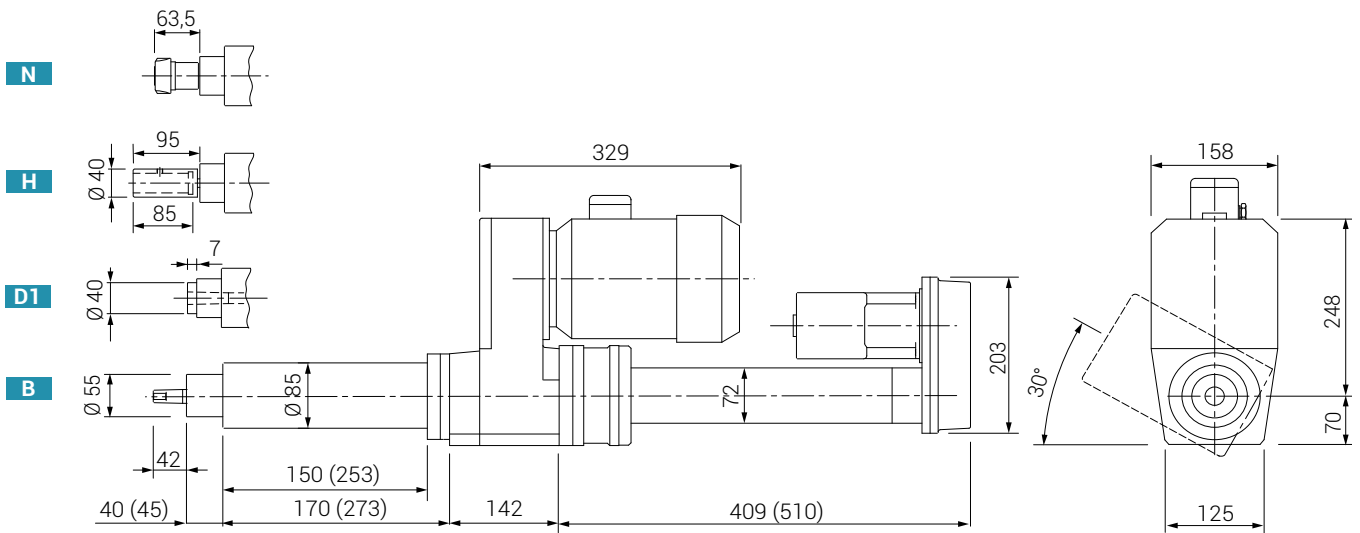

Dimension () are for the 130 mm stroke unit / (Quoten) = Einheit mit Hub 130

ACCESSORIES

(Page 42)

- Multi spindle heads
- Provision for brushless motor
- Provision for spindle motor
- For brackets see 3D pictures



ZUBEHÖR

(Seite 42)

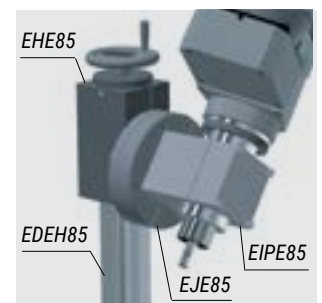
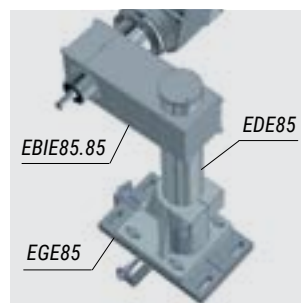
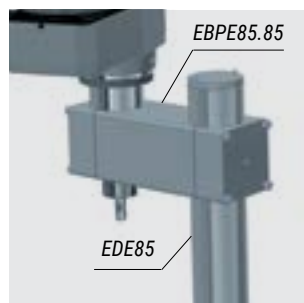
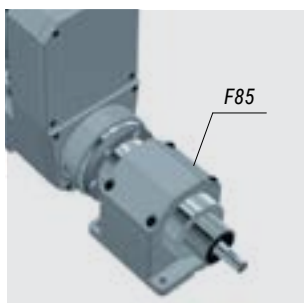
- Mehrspindelköpfe
- Vorbereitung für Servomotor
- Vorbereitung für Spindel
- Zubehör siehe 3D Abbildung



CNC Machining units CNC Bearbeitungseinheiten

	THRUST VORSCHUBKRAFT	7000 N
	WEIGHT GEWICHT	70 Kg

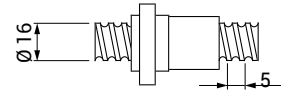

CAPACITY IN STEEL R=60
LEISTUNG IN STAHL R=60

Ø 25 / M30

STROKE
HUB

115 mm

TOOLHOLDER
WERKZEUGAUFNAHME

S = ISO 30 DIN 2079
O = HSK 50 C

SPINDLE RPM (50HZ) / SPINDEL DREHZAHL

D	300	R6P	CHAIN WITH REDUCER GETRIEBEKETTE
E	400		
F	500	6P	CHAIN KETTE
G	600		
H	800	6P	
I	1000		
J	1200		
K	1500		
L	1800	4P	TIMING BELT ZAHNRIEMEN
M	2000		
N	2400		
O	3000		
P	3600	2P	
Q	4000		

DXE 23 /115 /.. /.. /..

MOTOR / MOTOR

205	=	90	-	1,5 kW	2P
406	=	90	-	1,5 kW	4P
606	=	90	-	1,1 kW	6P

Max frame 112 / Max Größe 112

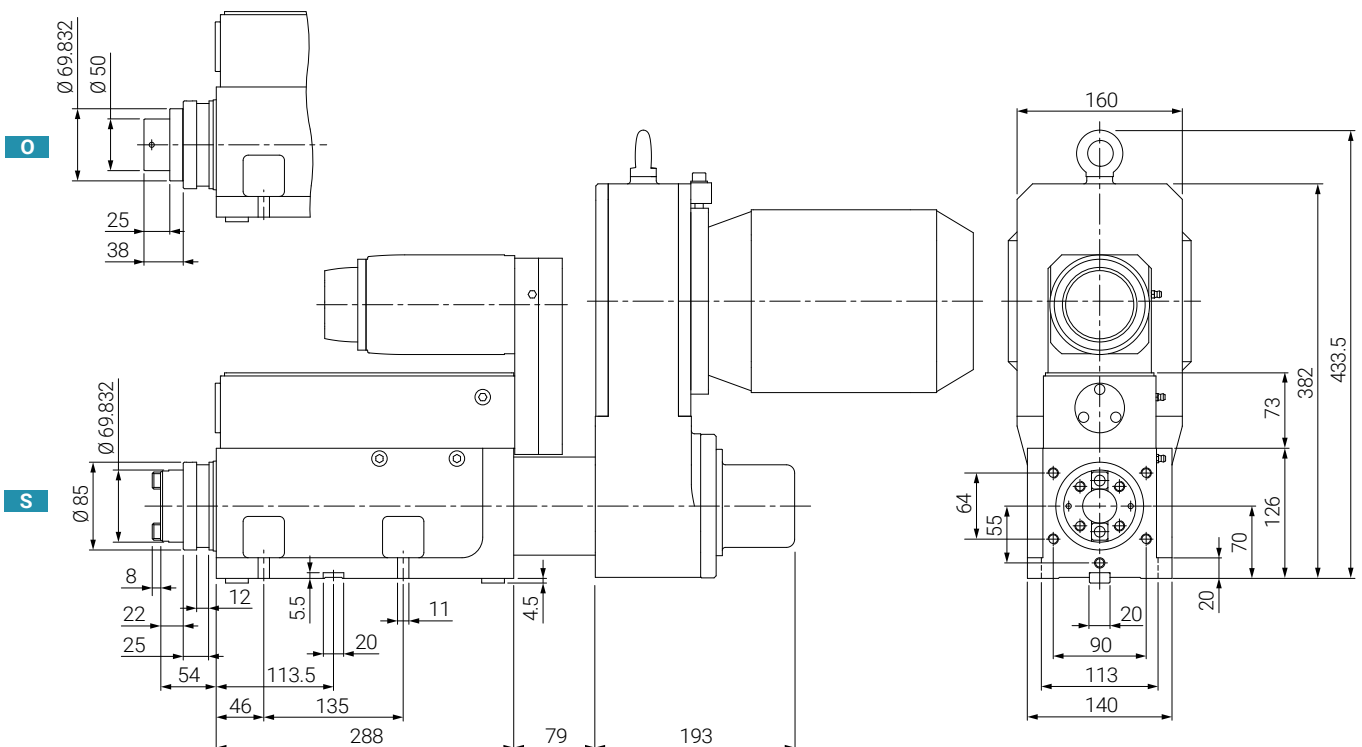



ACCESSORIES

- Supported by a set of taper roller bearings
- Multi spindle heads
- Provision for brushless motor
- Provision for spindle motor
- Coolant through facility

ZUBEHÖR

- Kegellager
- Mehrspindelköpfe
- Vorbereitung für Servomotor
- Vorbereitung für Spindel
- Mit Innenkühlung

CNC Machining units CNC Bearbeitungseinheiten

 THRUST VORSCHUBKRAFT	7000 N
 WEIGHT GEWICHT	88 Kg

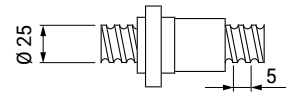

CAPACITY IN STEEL R=60
LEISTUNG IN STAHL R=60

Ø 26 / M30

STROKE
HUB

120 mm

TOOLHOLDER
WERKZEUGAUFNAHME

H1 = DIN 55058 Ø 28
S = ISO 30

SPINDLE RPM (50HZ) / SPINDEL DREHZAHL

D	300	R6P	CHAIN WITH REDUCER GETRIEBEKETTE
E	400		
F	500	6P	CHAIN KETTE
G	600		
H	800	6P	
I	1000		
J	1200		
K	1500		
L	1800	4P	TIMING BELT ZAHNRIEMEN
M	2000		
N	2400		
O	3000		
P	3600	2P	
Q	4000		

DXE 24 /120 /.. /.. /..

MOTOR / MOTOR

207	=	100	-	3 kW	2P
407	=	100	-	2,2 kW	4P
609	=	112	-	2,2 kW	6P

Max frame 112 / Max Größe 112

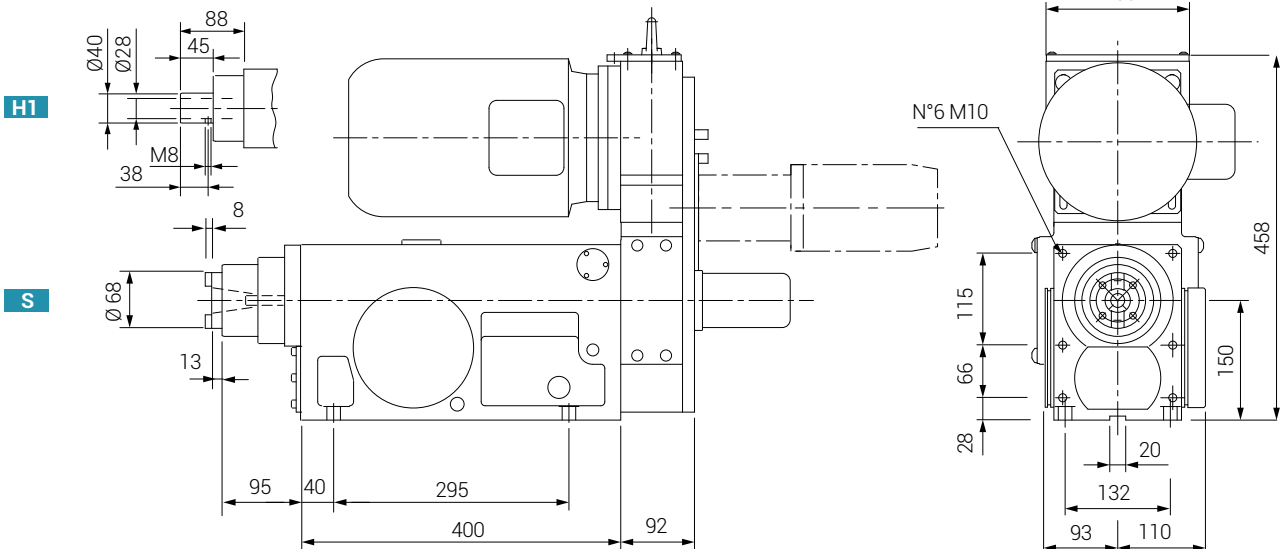

ACCESSORIES

- Supported by a set of taper roller bearings
- Multi spindle heads
- Provision for brushless motor
- Provision for spindle motor

ZUBEHÖR

- Kegelrollenlager
- Mehrspindelköpfe
- Vorbereitung für Servomotor
- Vorbereitung für Spindel

CNC Machining units CNC Bearbeitungseinheiten

 THRUST
VORSCHUBKRAFT 9700 N

 WEIGHT
GEWICHT 140 Kg

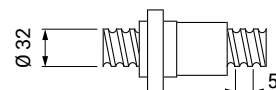

CAPACITY IN STEEL R=60
LEISTUNG IN STAHL R=60

Ø 38/ M40

STROKE
HUB

160 mm

TOOLHOLDER
WERKZEUGAUFNAHME

T= ISO 40

SPINDLE RPM (50HZ) / SPINDELDREHZAHL

A	160		
B	200	R6P	
C	250		CHAIN WITH REDUCER GETRIEBEBETTE
D	300		
E	400	R4P	
F	500		
G	600		
H	800	6P	
I	1000		
J	1200		
K	1500	4P	TIMING BELT ZAHNRIEMEN
L	1800		
M	2000		
N	2400		
O	3000	2P	
P	3600		
Q	4000		

DXE 42 /160 /.. /.. /..

MOTOR / MOTOR

207	=	100	-	3,00 kW	2P
407	=	100	-	2,2 kW	4P
609	=	112	-	2,2 kW	6P

Max frame 112 / Max Größe 112

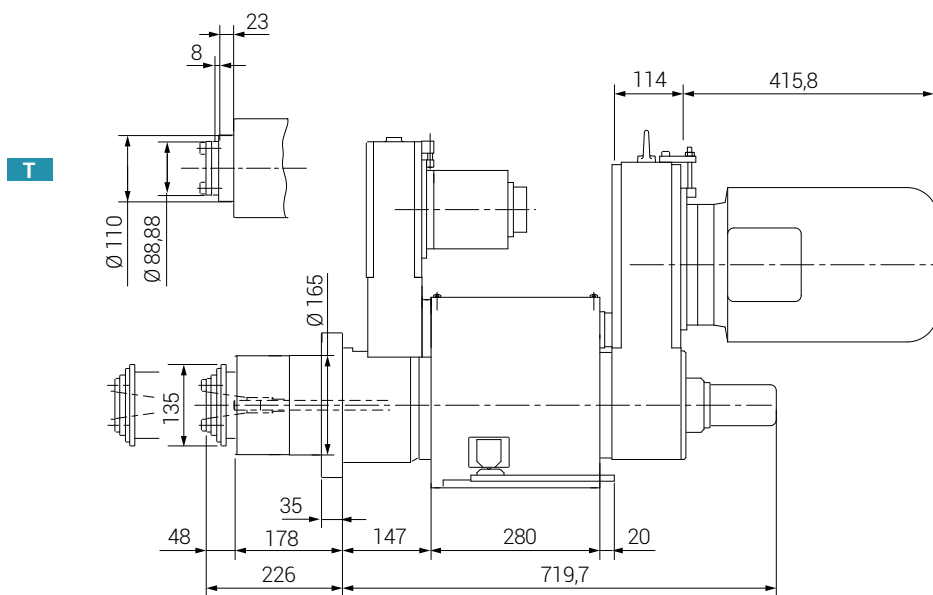

ACCESSORIES

- Multi spindle heads
- Provision for brushless motor
- Provision for spindle motor

ZUBEHÖR

- Mehrspindelköpfe
- Vorbereitung für Servomotor
- Vorbereitung für Spindel



Tapping units Gewindeschneideinheiten

FEATURES

- *Sliding with grooved profile*
- *Speed range up to 15 possibilities*
- *Pneumatic feed on request*
- *Quick replacement of the lead screw (6 min)*

EIGENSCHAFTEN

- Schiebeführung mit Rillenprofil
- Geschwindigkeitsbereich mit bis zu 15 Möglichkeiten
- Pneumatischer Vorshub auf Anfrage
- Leitpatronenwechsel (6 min)

Tapping units Gewindeschneideinheiten

 LEAD SCREW
LEITPATRONE

 WEIGHT
GEWICHT

16 - 20 Kg

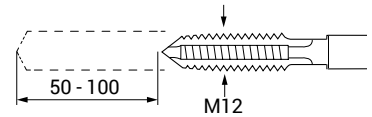

TAPPING CAPACITY IN STEEL R=60
SCHNEIDLEISTUNG IN STAHL R=60

M12

MECHANICAL FEED
MECHANISCHER VORSCHUB

50 mm
100 mm

TOOLHOLDER
WERKZEUGAUFNAHME

A = B12 DIN 238
F = DIN 55058 Ø 16
L = ER20

SPINDLE RPM (50HZ) / SPINDEL DREHZAHL

A	160	R6P	CHAIN WITH REDUCER GETRIEBEKETTE
B	200		
C	250		
D	300		
E	400	6P	CHAIN KETTE
F	500		
G	600	4P	TIMING BELT ZAHNRIEMEN
H	800		
I	1000		
J	1200		
K	1500	2P	
L	1800		
M	2000		
N	2400		
O	3000		

TX 12 /.. /.. /.. /.. /*

MOTOR / MOTOR

203	=	80	-	0,75 kW	2P
403	=	80	-	0,55 kW	4P
604	=	80	-	0,55 kW	6P

Max frame 80 / Max Größe 80

LEAD SCREW PITCH
STEIGUNG DER LEITPATRONE

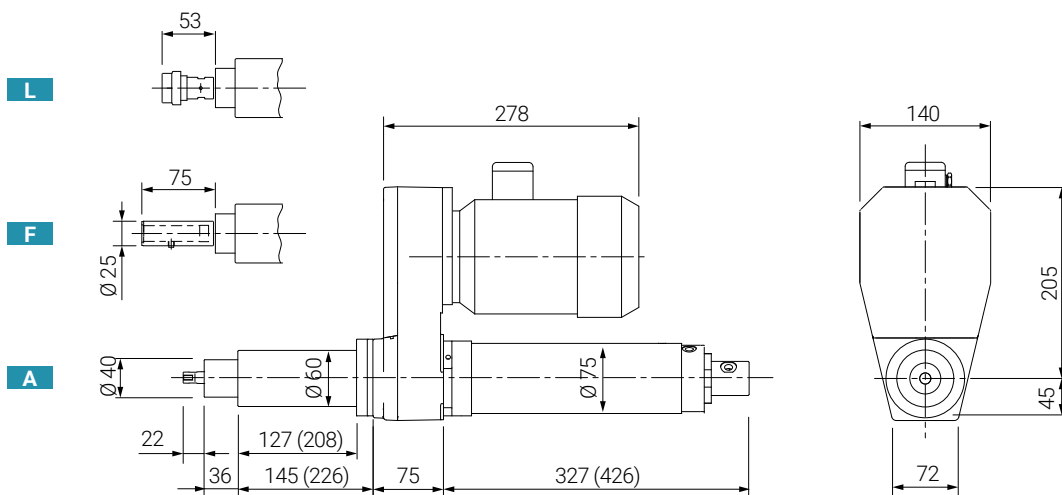

Dimension () are for the 100 mm stroke unit / (Quoten) = Einheit mit Hub 100

ACCESSORIES

(Page 42)

- Multi spindle heads
- Selfbreaking motor on request
- For brackets see 3D pictures

ZUBEHÖR

(Seite 42)

- Mehrspindelköpfe
- Bremsmotor auf Anfrage
- Zubehör siehe 3D Abbildung

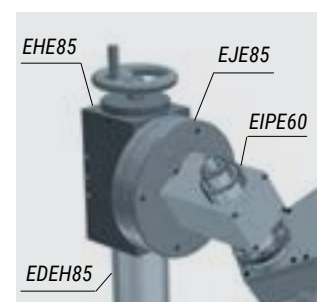
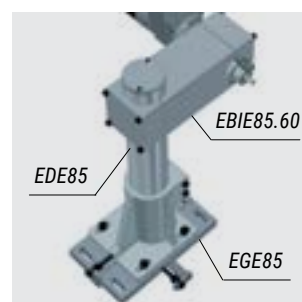
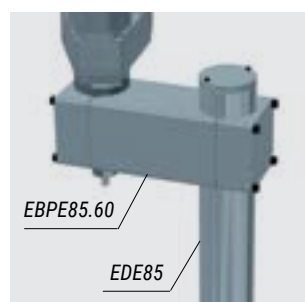
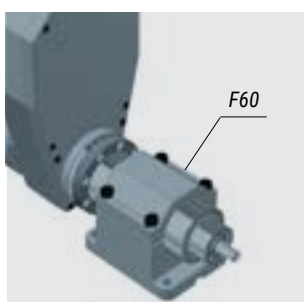

Tapping units Gewindeschneideinheiten

 LEAD SCREW
LEITPATRONE

 WEIGHT
GEWICHT

36-40 Kg

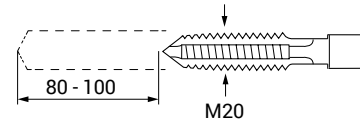

TAPPING CAPACITY IN STEEL R=60
SCHNEIDLEISTUNG IN STAHL R=60

M20

MECHANICAL FEED
MECHANISCHER VORSCHUB

80 mm
100 mm

TOOLHOLDER
WERKZEUGAUFNAHME

B = B18 DIN 238
D = MORSE 2
H = DIN 55058 Ø 28
N = ER32

SPINDLE RPM (50HZ) / SPINDELREHZAHL

A	160		
B	200	R6P	CHAIN WITH REDUCER GETRIEBEKETTE
C	250		
D	300		
E	400		CHAIN KETTE
F	500	6P	
G	600		
H	800	6P	
I	1000		
J	1200		TIMING BELT ZAHNRIEMEN
K	1500	4P	
L	1800		
M	2000		

TX 20 /.. /.. /.. /.. /*

MOTOR / MOTOR

406 = 90 - 1,50 kW 4P
606 = 90 - 1,10 kW 6P

Max frame 112 / Max Größe 112

LEAD SCREW PITCH
STEIGUNG DER LEITPATRONE

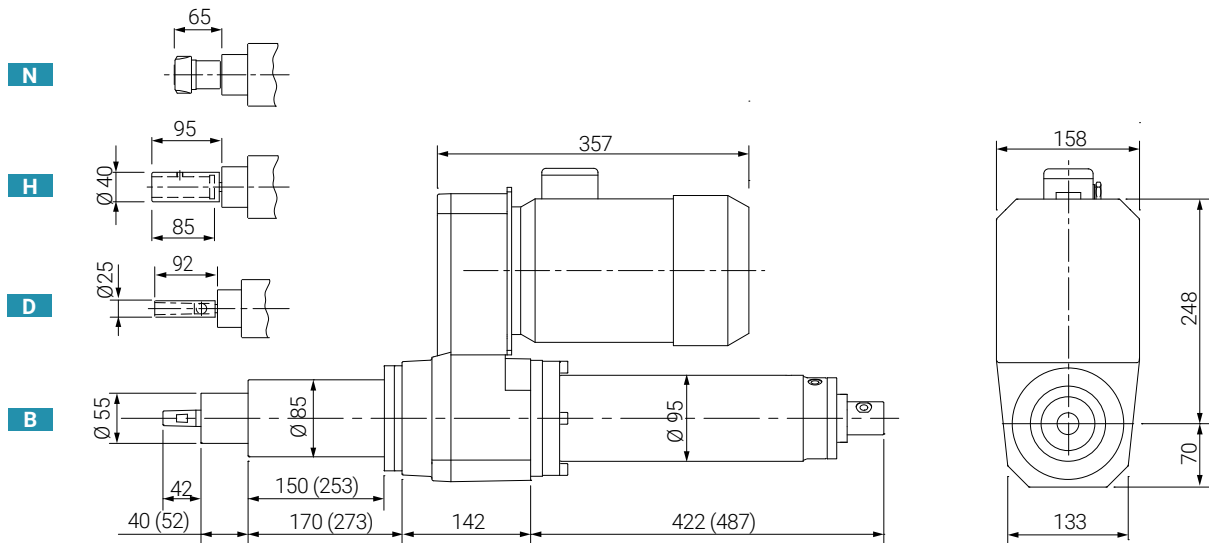

Dimension () are for the 100 mm stroke unit / (Quoten) = Einheit mit Hub 100

ACCESSORIES

(Page 42)

- Multi spindle heads
- Selfbreaking motor on request
- For brackets see 3D pictures

ZUBEHÖR

(Seite 42)

- Mehrspindelköpfe
- Bremsmotor auf Anfrage
- Zubehör siehe 3D Abbildung

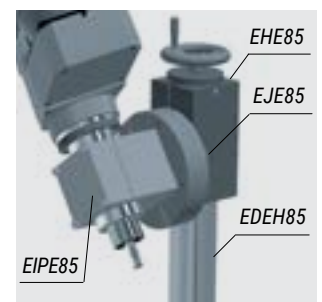
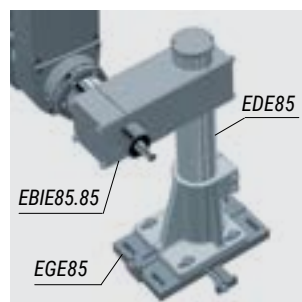
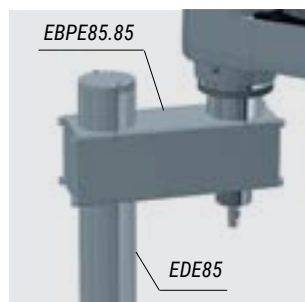
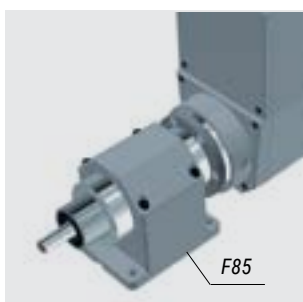

Tapping units Gewindeschneideinheiten

 LEAD SCREW
LEITPATRONE

 WEIGHT
GEWICHT

98 Kg

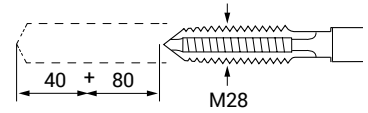

TAPPING CAPACITY IN STEEL R=60
SCHNEIDLEISTUNG IN STAHL R=60

M28

FAST STROKE
EILVORSCHUB

80 mm

TAPPING STROKE
ARBEITSVORSCHUB

40 mm

TOOLHOLDER
WERKZEUGAUFNAHME

H2 = DIN 55058 Ø 28

I = DIN 55058 Ø 36

SPINDLE RPM (50HZ) / SPINDEL DREHZAHL

A2	100	
A	160	
B	200	6P
D	300	
F	500	
G	600	4P

BELT
ZAHNRIEMEN

TX 28 /120 /.. /.. /.. /*

MOTOR / MOTOR

408 = 100 - 3,00 kW 4P

609 = 112 - 2,20 kW 6P

Max frame 112 / Max Größe 112

LEAD SCREW PITCH
STEIGUNG DER LEITPATRONE

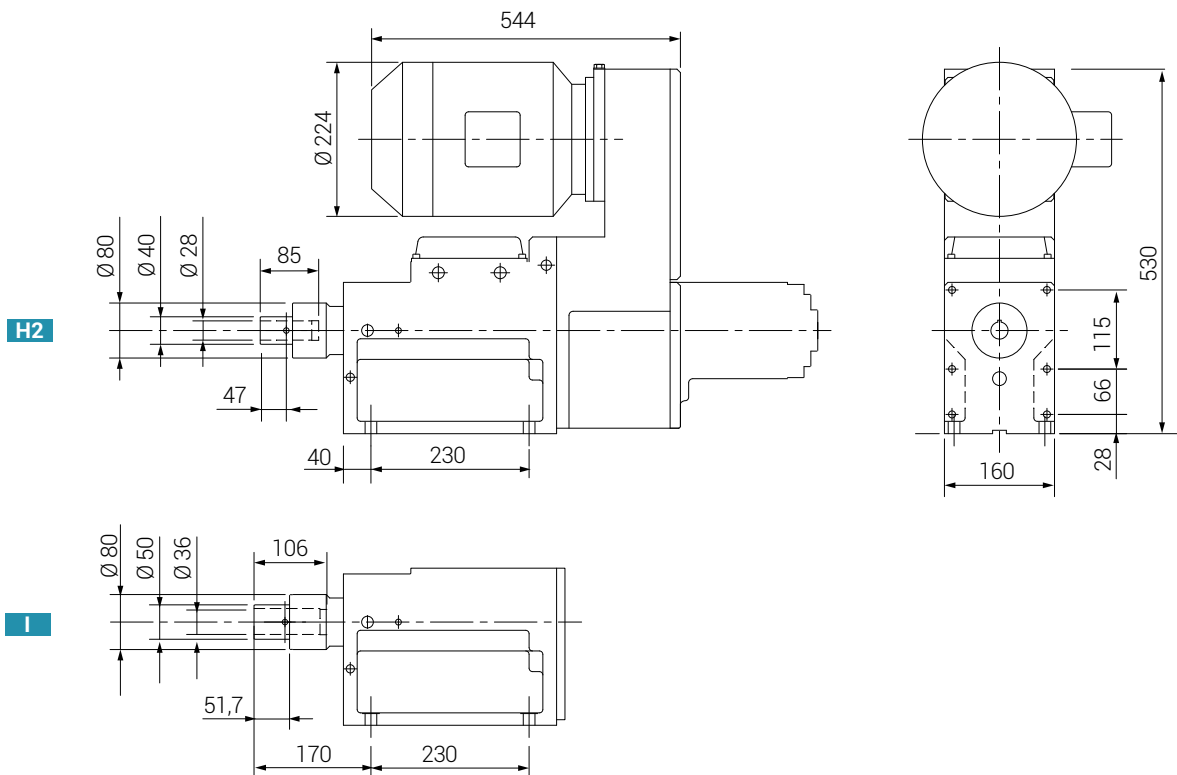

ACCESSORIES

- Multi spindle heads
- Selfbreaking motor on request

ZUBEHÖR

- Mehrspindelköpfe
- Bremsmotor auf Anfrage

Tapping units Gewindeschneideinheiten

 LEAD SCREW
LEITPATRONE

 WEIGHT
GEWICHT

140-145Kg

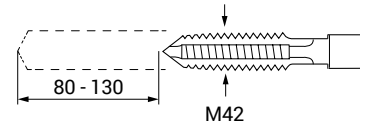

TAPPING CAPACITY IN STEEL R=60
SCHNEIDLEISTUNG IN STAHL R=60

M42

MECHANICAL FEED
MECHANISCHER VORSCHUB

80 mm
130 mm

TOOLHOLDER
WERKZEUGAUFNAHME

I = DIN 55058 Ø 36

SPINDLE RPM (50HZ) / SPINDELDREHZAHL

A2	100	
A	160	
B	200	6P
D	300	
F	500	
G	600	4P

CHAIN
KETTE

TX 42 /.. /.. /.. /.. /*

MOTOR / MOTOR

408 = 100 - 3,00 kW 4P
609 = 112 - 2,20 kW 6P

Max frame 112 / Max Größe 112

LEAD SCREW PITCH
STEIGUNG DER LEITPATRONE

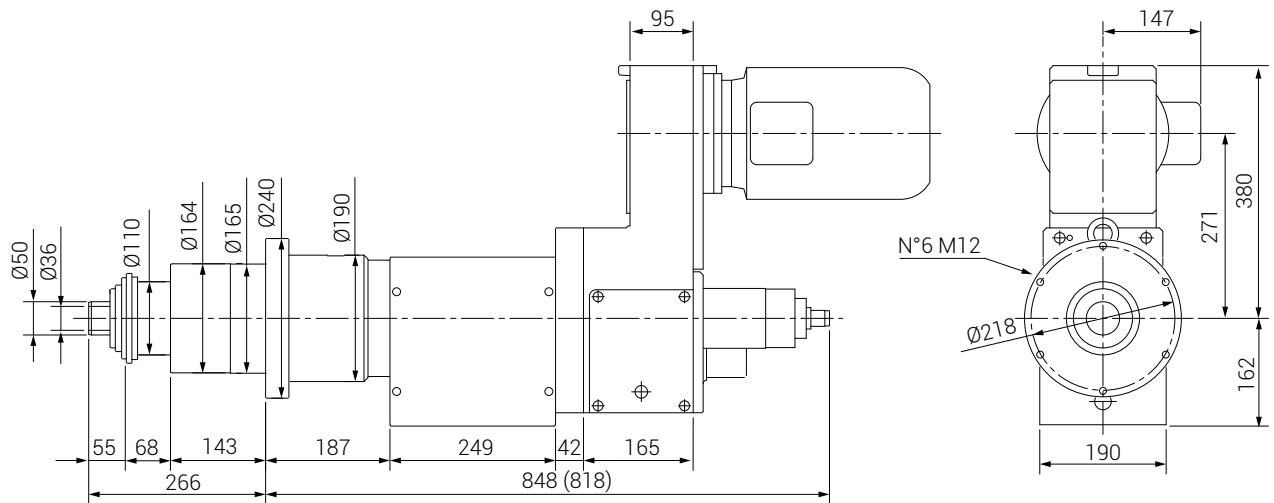

Dimension () are for the 130 mm stroke unit / (Quoten) = Einheit mit Hub 130

ACCESSORIES

- Multi spindle heads
- Selfbreaking motor on request

ZUBEHÖR

- Mehrspindelköpfe
- Bremsmotor auf Anfrage

Lead screw Leitpatrone

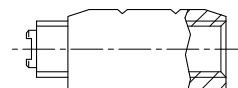



METRIC THREADS R.H. (Optional L.H.)
METRISCHE GEWINDE RECHTSGEWINDE (Optional Linksgewinde)

IMPERIAL THREADS R.H. (Optional L.H.)
ZOLLGEWINDE RECHTSGEWINDE (Optional Linksgewinde)

UNIT EINHEIT	MODEL TYP	PITCH STEIGUNG
TX12.50 / 100 TX20.100	M.TKS.50.M	0.35
	M.TKS.50.M	0.40
	M.TKS.50.M	0.45
	M.TKS.50.M	0.50
	M.TKS.50.M	0.60
	M.TKS.50.M	0.70
	M.TKS.50.M	0.75
	M.TKS.50.M	0.80
	M.TKS.50.M	1
	M.TKS.50.M	1.25
	M.TKS.50.M	1.50
	M.TKS.50.M	1.75
TX20.80	M.TKM.80.M	0.50
	M.TKM.80.M	0.60
	M.TKM.80.M	0.70
	M.TKM.80.M	0.75
	M.TKM.80.M	0.80
	M.TKM.80.M	1
	M.TKM.80.M	1.25
	M.TKM.80.M	1.50
	M.TKM.80.M	1.75
	M.TKM.80.M	2
	M.TKM.80.M	2.50
	M.TKM.80.M	3
TX28.80 TX42.80 / 130	M.TKL.80.M	0.50
	M.TKL.80.M	0.60
	M.TKL.80.M	0.70
	M.TKL.80.M	0.75
	M.TKL.80.M	0.80
	M.TKL.80.M	1
	M.TKL.80.M	1.25
	M.TKL.80.M	1.50
	M.TKL.80.M	1.75
	M.TKL.80.M	2
	M.TKL.80.M	2.50
	M.TKL.80.M	3

UNIT EINHEIT	MODEL TYP	PITCH STEIGUNG
TX12.50 / 100 TX20.100	M.TKS.50.I	72
	M.TKS.50.I	64
	M.TKS.50.I	56
	M.TKS.50.I	48
	M.TKS.50.I	44
	M.TKS.50.I	40
	M.TKS.50.I	36
	M.TKS.50.I	32
	M.TKS.50.I	28
	M.TKS.50.I	27
	M.TKS.50.I	24
	M.TKS.50.I	20
TX20.80	M.TKS.50.I	19
	M.TKS.50.I	18
	M.TKM.80.I	28
	M.TKM.80.I	27
	M.TKM.80.I	24
	M.TKM.80.I	20
	M.TKM.80.I	19
	M.TKM.80.I	18
	M.TKM.80.I	16
	M.TKM.80.I	14
	M.TKM.80.I	13
	M.TKM.80.I	12
M.TKM.80.I	11½	
M.TKM.80.I	11	
M.TKM.80.I	10	
M.TKM.80.I	9	
M.TKM.80.I	8	
M.TKM.80.I	7	
TX28.80 TX42.80 / 130	M.TKL.80.I	28
	M.TKL.80.I	27
	M.TKL.80.I	24
	M.TKL.80.I	20
	M.TKL.80.I	19
	M.TKL.80.I	18
	M.TKL.80.I	16
	M.TKL.80.I	14
	M.TKL.80.I	13
	M.TKL.80.I	12
	M.TKL.80.I	11½
	M.TKL.80.I	11
M.TKL.80.I	10	
M.TKL.80.I	9	
M.TKL.80.I	8	
M.TKL.80.I	7	

Units for combined drill-tapping Bohr- und Gewindeschneideinheiten

 THRUST VORSCHUBKRAFT	1350 N
 WEIGHT GEWICHT	16-21 Kg

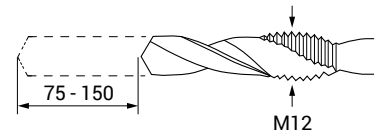

TAPPING CAPACITY IN STEEL R=60
SCHNEIDLEISTUNG IN STAHL R=60

M12

STROKE
HUB

75 mm
150 mm

TOOLHOLDER
WERKZEUGAUFNAHME

A = B12 DIN 238
LC = ER20
Compensated / Spannzangenhalter

SPINDLE RPM (50HZ) / SPINDEL DREHZAHL

Z1 750 4/6 P
1200

Z2 1200 2/4P TIMING BELT
2400 ZAHNRIEMEN

Z3 2000 2/4P
4000

DTX 12 /.. /.. /.. /.. /..

MOTOR / MOTOR

901 = 80 - 0.8/0.6 kW 2/4 P
902 = 80 - 0.55/0.45 kW 4/6 P

Max frame 80 / Max Größe 80

HYDROCHECK / HYDRAULIKBREMSE

HF50 = STROKE/ HUB 50 mm
HF75 = STROKE/ HUB 75 mm
HF100 = STROKE/ HUB 100 mm

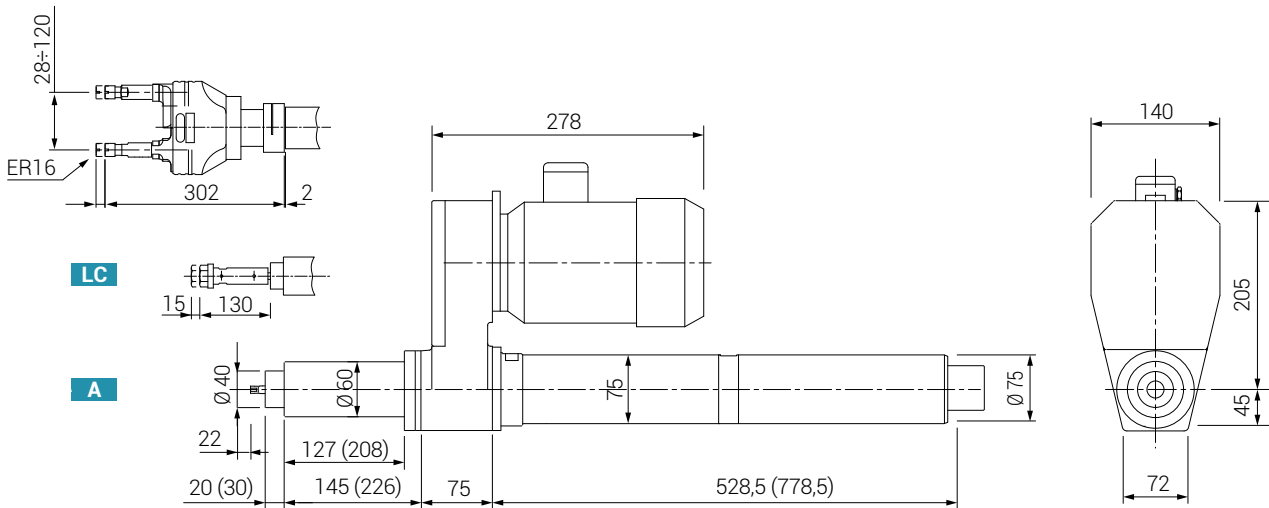

Dimension () are for the 150 mm stroke unit / (Quoten) = Einheit mit Hub 150

ACCESSORIES

(Page 42)

- Multi spindle heads with compensating spindle
- Selfbreaking motor on request
- Double polarity motor
- For brackets see 3D pictures



ZUBEHÖR

(Seite 42)

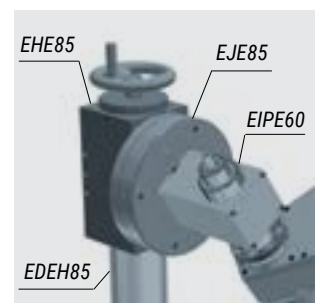
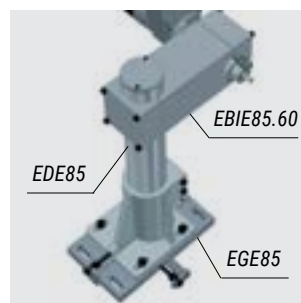
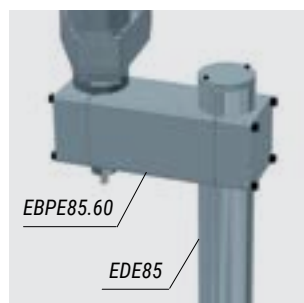
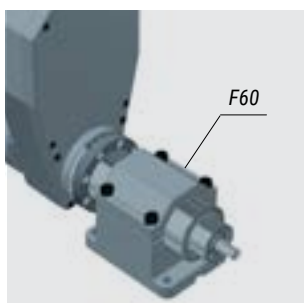
- Mehrspindelköpfe mit Kompensierte Spindel
- Bremsmotor auf Anfrage
- Polumschaltbarer Motor
- Zubehör siehe 3D Abbildung



Units for combined drill-tapping Bohr- und Gewindeschneideinheiten

	THRUST VORSCHUBKRAFT	4000 N
	WEIGHT GEWICHT	45-49 Kg

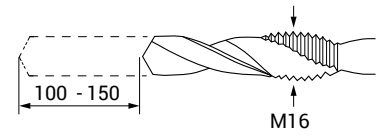

TAPPING CAPACITY IN STEEL R=60
SCHNEIDLEISTUNG IN STAHL R=60

M16

STROKE
HUB

100 mm
150 mm

TOOLHOLDER
WERKZEUGAUFNAHME

B = B18 DIN 238
LX = ER20
Compensated / Spannzangenhalter

SPINDLE RPM (50HZ) / SPINDEL DREHZAHL

Z1 750 4/6 P
1200

Z2 1200 2/4 P
2400

Z3 2000 2/4 P
4000

TIMING BELT
ZAHNRIEMEN

DTX 16 /.. /.. /.. /.. /..

MOTOR / MOTOR

903 = 90 - 1.3/1.1 kW 2/4 P
904 = 90 - 1.1/0.75 kW 4/6 P

Max frame 112 / Max Größe 112

HYDROCHECK / HYDRAULIKBREMSE

HF50 = STROKE/ HUB 50 mm
HF75 = STROKE/ HUB 75 mm
HF100 = STROKE/ HUB 100 mm

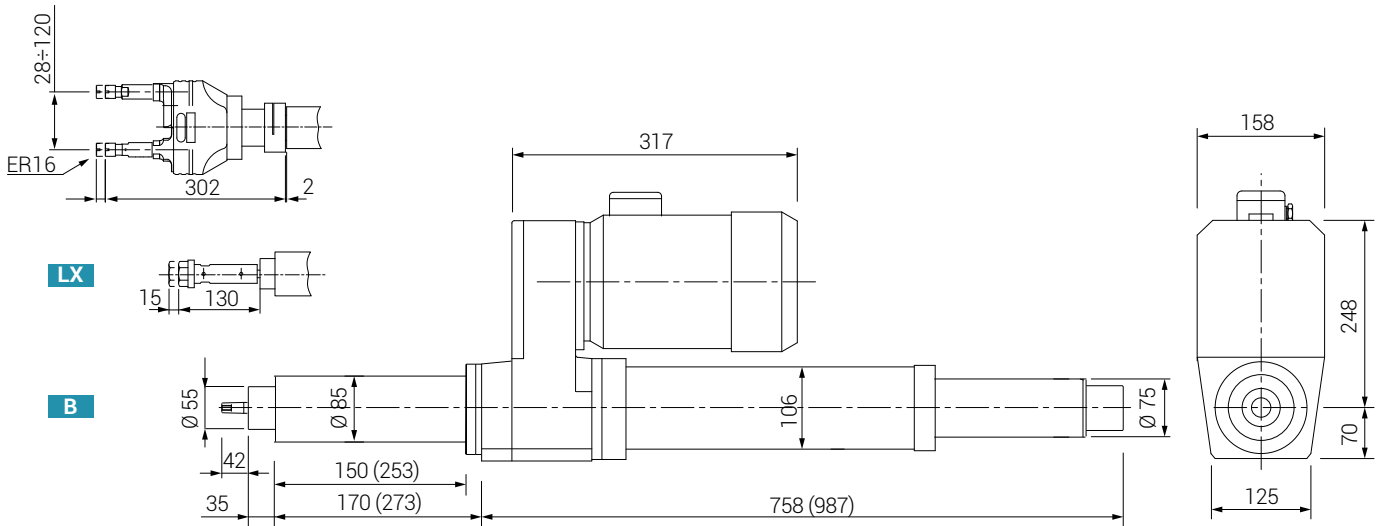

Dimension () are for the 150 mm stroke unit / (Quoten) = Einheit mit Hub 150

ACCESSORIES

(Page 42)

- Multi spindle heads with compensating spindle
- Selfbreaking motor on request
- Double polarity motor
- For brackets see 3D pictures

ZUBEHÖR

(Seite 42)

- Mehrspindelköpfe mit Kompensierte Spindel
- Bremsmotor auf Anfrage
- Polumschaltbarer Motor
- Zubehör siehe 3D Abbildung

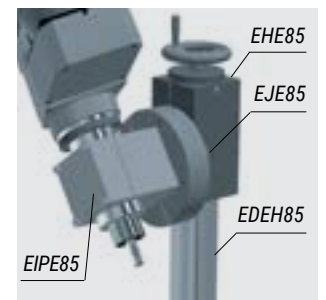
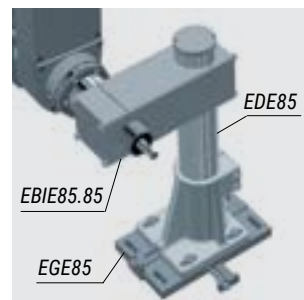
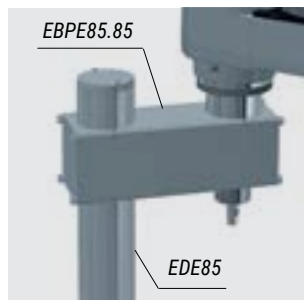
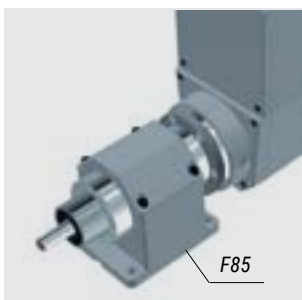



Machining spindles Spindeleinheiten



FEATURES

- *High speed and high accuracy bearings*
 - *Coolant through drawbar*
 - *Rotating adapter union*
- *Hydraulic quick change tool clamping system with or without central cooling lubrication supply*

EIGENSCHAFTEN

- *Präzisionsschräggugellager*
- *Kühlmittelzuführung durch die Zugstange*
 - *Auskuppelbarer Dreheverteiler*
- *Hydraulisches Werkzeugwechselsystem mit Kühlmittelzuführung und Drehverteiler*

Machining spindles Spindeleinheiten

	MAX AXIAL LOAD MAX AXIALE BELASTUNG	2500 N
	WEIGHT GEWICHT	20 Kg

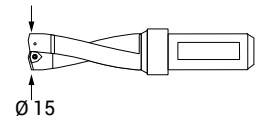

SPINDLE RPM (50HZ) / SPINDELDREHZAHL

G	600	
H	800	6P
I	1000	
J	1200	
K	1500	
L	1800	4P
M	2000	
N	2400	
O	3000	2P
P	3600	
Q	4000	
R	4500	
S	5400	
T	6400	2P
U	7500	
V	8400	

TIMING BELT
ZAHNRIEMEN

POLY - V BELT
POLY - V RIEMEN

DRILLING CAPACITY
IN STEEL R=60
BOHRLEISTUNG
IN STAHL R=60

Ø 15

MOTOR / MOTOR

205	=	90	-	1.5 kW	2P
406	=	90	-	1.5 kW	4P
606	=	90	-	1.1 kW	6P

Max frame 90 / Max Größe 90

TOOLHOLDER WERKZEUGAUFNAHME

S = ISO 30 DIN 2079
O = HSK 50 C

DX 22 /.. /.. /.. /..

BEARINGS / LAGERUNG

RC = *Taper roller bearings / Kegelrollenlager*
CO = *Double pair of angular contact bearings/ Doppelpaar Schrägkugellager*

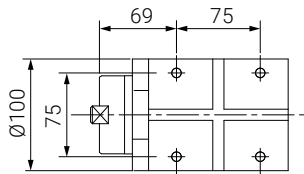

O

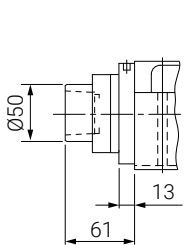

S

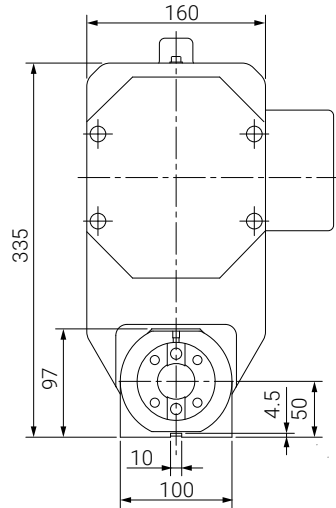
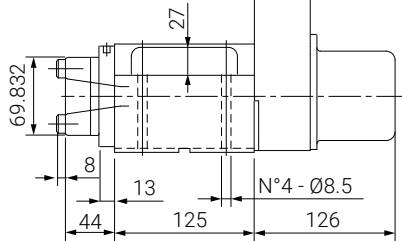

COOLANT THROUGH FACILITY MIT INNENKÜHLUNG

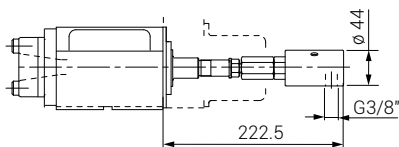

MULTI-SPINDLE HEAD MOUNTING FLANGE AUFNAHME MEHRSPINDELKÖPFE

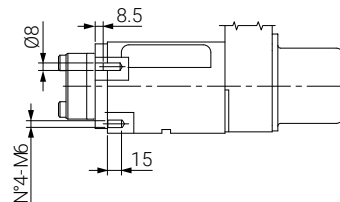

Machining spindles Spindeleinheiten

MAX AXIAL LOAD
 MAX AXIALE BELASTUNG **9000 N**
 WEIGHT
 GEWICHT **40 - 50 Kg**

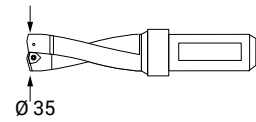

SPINDLE RPM (50HZ) / SPINDELDREHZAHL			CHAIN KETTE	TIMING BELT ZAHNRIEMEN	POLY - V BELT POLY - V RIEMEN
E	400	6P			
F	500				
G	600				
H	800	6P			
I	1000				
J	1200				
K	1500				
L	1800	4P			
M	2000				
N	2400				
O	3000	2P			
P	3600				
Q	4000				
R	4500				
S	5400				
T	6400	2P			
U	7500				
V	8400				

MAX. DRILLING CAPACITY IN STEEL R=60
MAX. BOHRLEISTUNG IN STAHL R=60
Ø 35

MOTOR ISO 30 / MOTOR ISO 30 **MOTOR ISO 40 / MOTOR ISO 40**
 205 = 90 - 1.5 kW 2P 207 = 100 - 3 kW 2P
 406 = 90 - 1.5 kW 4P 407 = 100 - 2.2 kW 4P
 606 = 90 - 1.1 kW 6P 607 = 100 - 1.5 kW 6P
Max frame 112 / Max Größe 112

TOOLHOLDER WERKZEUGAUFNAHME
P = HSK 63 A
Q = HSK 63 C
S = ISO 30 DIN 2079
T = ISO 40 DIN 2079

BEARINGS / LAGERUNG
RC = *Taper roller bearings / Kegelrollenlager*
CO = *Double pair of angular contact bearings / Doppelpaar Schrägkugellager*

DX 28 /.. /.. /.. /..

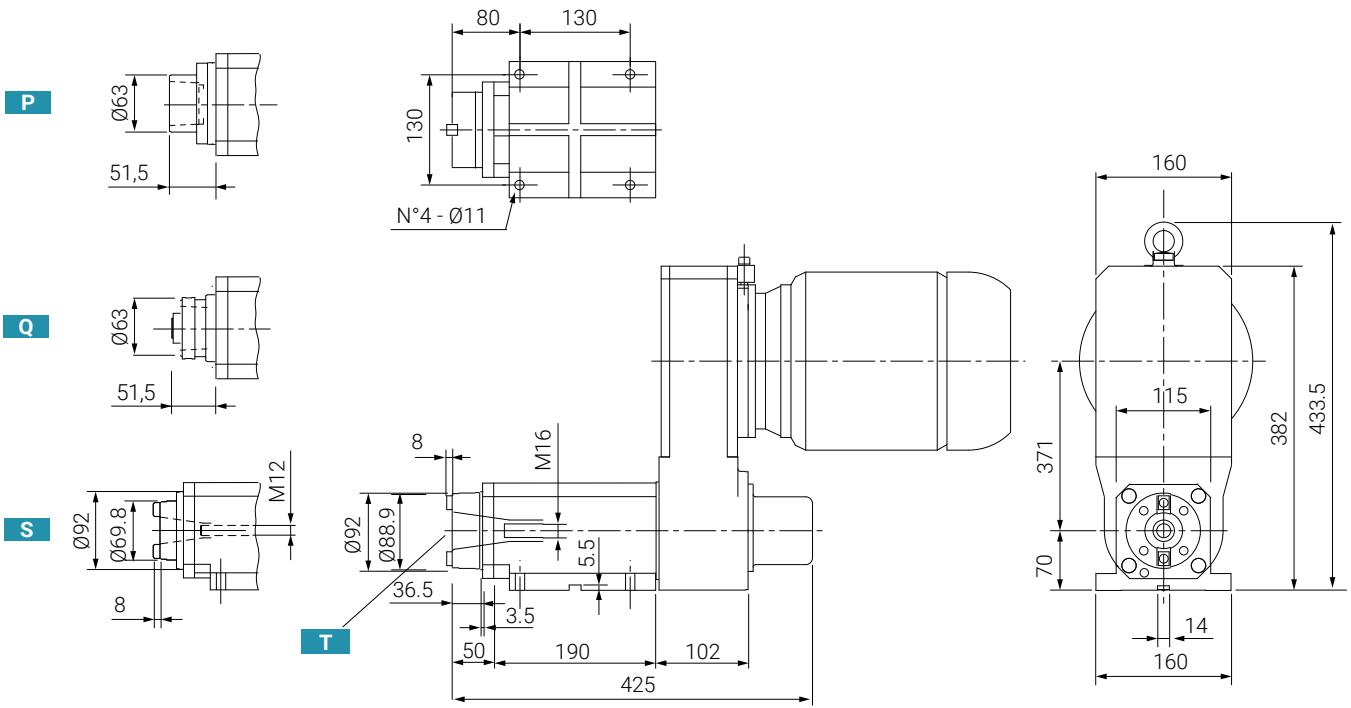

**COOLANT THROUGH FACILITY
MIT INNENKÜHLUNG**

**HYDRAULICALLY UNCLAMPED (ISO40)
HYDRAULISCHE ENTSPANNUNG (ISO40)**

**PNEUMATICALLY UNCLAMPED
VORBEREITUNG FÜR INNENKÜHLUNG**

Dimension () are for the ISO 40 / HSK 63 A toolholder unit
(Quoten) = werkzeugaufnahmen ISO 40 / HSK 63 A

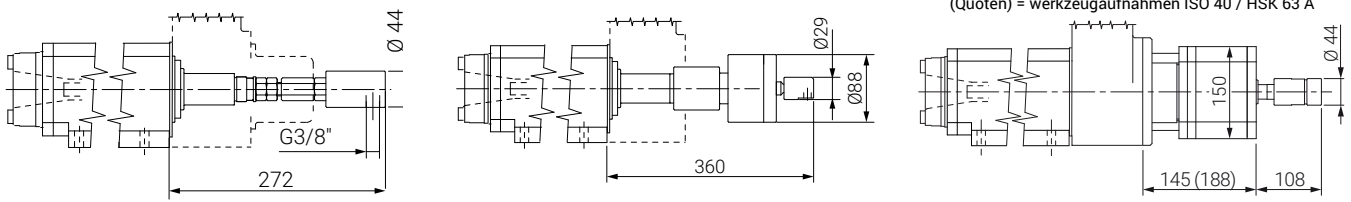

Machining spindles Spindeleinheiten

MAX AXIAL LOAD
 MAX AXIALE BELASTUNG **15000 N**
 WEIGHT
 GEWICHT **90-100Kg**

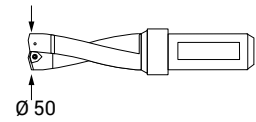

SPINDLE RPM (50HZ) / SPINDELDREHZAHL

A	160	
B	200	R6P
C	250	
D	300	
E	400	R4P
F	500	
G	600	
H	800	6P
I	1000	
J	1200	
K	1500	4P
L	1800	
M	2000	
N	2400	
O	3000	2P
P	3600	

CHAIN WITH REDUCER
GETRIEBEKETTE

TIMING BELT ZAHNRIEMEN

MAX. DRILLING CAPACITY IN STEEL R=60
MAX. BOHRLEISTUNG IN STAHL R=60

Ø 50

MOTOR ISO 40 / MOTOR ISO 40

207	=	100	-	3 kW	2P
407	=	100	-	2.2 kW	4P
609	=	112	-	2.2 kW	6P

MOTOR ISO 50 / MOTOR ISO 50

209	=	132	-	5.5 kW	2P
410	=	132	-	5.5 kW	4P
611	=	132	-	4 kW	6P

Max frame 132 / Max Größe 132

DX 38 /.. /.. /.. /..

TOOLHOLDER WERKZEUGAUFNAHME

P = HSK 63 A
Q = HSK 63 C
T = ISO 40 DIN 2079
U = ISO 50 DIN 2079

BEARINGS / LAGERUNG

RC = Taper roller bearings / Kegelrollenlager
CO = Angular contact bearings/ Schrägkugellager

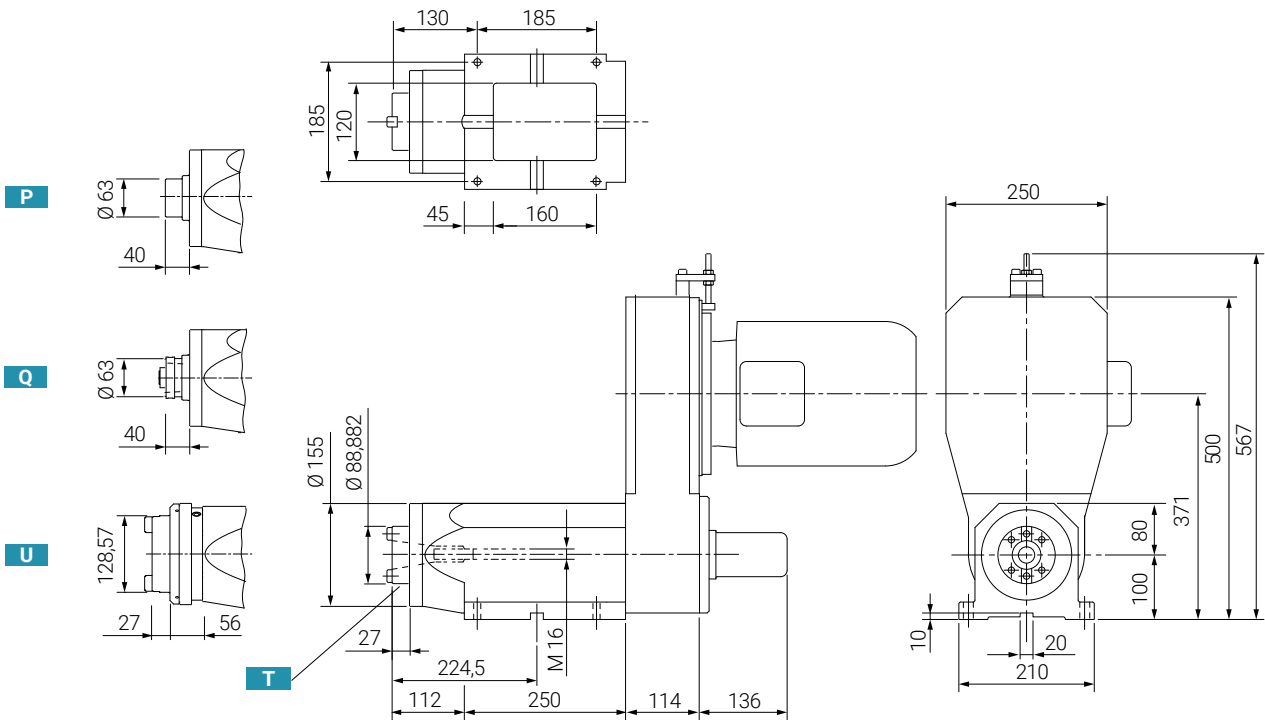

COOLANT THROUGH FACILITY
MIT INNENKÜHLUNG



HYDRAULICALLY UNCLAMPED
HYDRAULISCHE ENTSPANNUNG

PNEUMATICALLY UNCLAMPED
VORBEREITUNG FÜR INNENKÜHLUNG

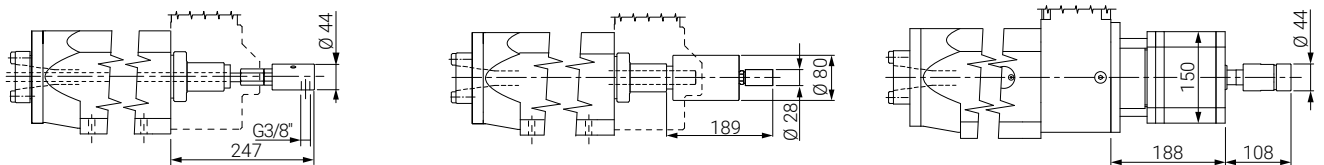
Just for ISO 40 / HSK 63 A
Nur für ISO 40 / HSK 63 A



Machining spindles Spindeleinheiten

	MAX AXIAL LOAD MAX AXIALE BELASTUNG	15000 N
	WEIGHT GEWICHT	120-130Kg

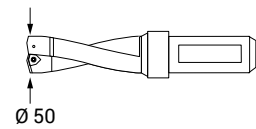

<p>SPINDLE RPM (50HZ) / SPINDELDREHZAHL</p> <table border="1"> <tr><td>A</td><td>160</td><td></td></tr> <tr><td>B</td><td>200</td><td>R6P</td></tr> <tr><td>C</td><td>250</td><td></td></tr> <tr><td>D</td><td>300</td><td></td></tr> <tr><td>E</td><td>400</td><td>R4P</td></tr> <tr><td>F</td><td>500</td><td></td></tr> <tr><td>G</td><td>600</td><td></td></tr> <tr><td>H</td><td>800</td><td>6P</td></tr> <tr><td>I</td><td>1000</td><td></td></tr> <tr><td>J</td><td>1200</td><td></td></tr> <tr><td>K</td><td>1500</td><td>4P</td></tr> <tr><td>L</td><td>1800</td><td></td></tr> <tr><td>M</td><td>2000</td><td></td></tr> <tr><td>N</td><td>2400</td><td></td></tr> <tr><td>O</td><td>3000</td><td>2P</td></tr> <tr><td>P</td><td>3600</td><td></td></tr> </table> <p>CHAIN WITH REDUCER GETRIEBEKETTE</p> <p>TIMING BELT ZAHNRIEMEN</p>	A	160		B	200	R6P	C	250		D	300		E	400	R4P	F	500		G	600		H	800	6P	I	1000		J	1200		K	1500	4P	L	1800		M	2000		N	2400		O	3000	2P	P	3600		<p>DRILLING CAPACITY IN STEEL R=60 BOHRLEISTUNG IN STAHL R=60</p> <p>Ø 50</p>	<p>MOTOR / MOTOR</p> <table border="1"> <tr><td>207</td><td>=</td><td>100</td><td>-</td><td>3 kW</td><td>2P</td></tr> <tr><td>407</td><td>=</td><td>100</td><td>-</td><td>2.2 kW</td><td>4P</td></tr> <tr><td>609</td><td>=</td><td>112</td><td>-</td><td>2.2 kW</td><td>6P</td></tr> </table> <p>Max frame 132 / Max Größe 132</p>	207	=	100	-	3 kW	2P	407	=	100	-	2.2 kW	4P	609	=	112	-	2.2 kW	6P	<p>TOOLHOLDER WERKZEUGAUFNAHME</p> <p>TL = ISO 40 DIN 69871 - LONG</p>
A	160																																																																				
B	200	R6P																																																																			
C	250																																																																				
D	300																																																																				
E	400	R4P																																																																			
F	500																																																																				
G	600																																																																				
H	800	6P																																																																			
I	1000																																																																				
J	1200																																																																				
K	1500	4P																																																																			
L	1800																																																																				
M	2000																																																																				
N	2400																																																																				
O	3000	2P																																																																			
P	3600																																																																				
207	=	100	-	3 kW	2P																																																																
407	=	100	-	2.2 kW	4P																																																																
609	=	112	-	2.2 kW	6P																																																																

DX 38L /.. /.. /.. /.. (S)

BEARINGS / LAGERUNG
RC = Taper roller bearings / Kegelrollenlager
CO = Double pair of angular contact bearings/ Doppelpaar Schrägkugellager

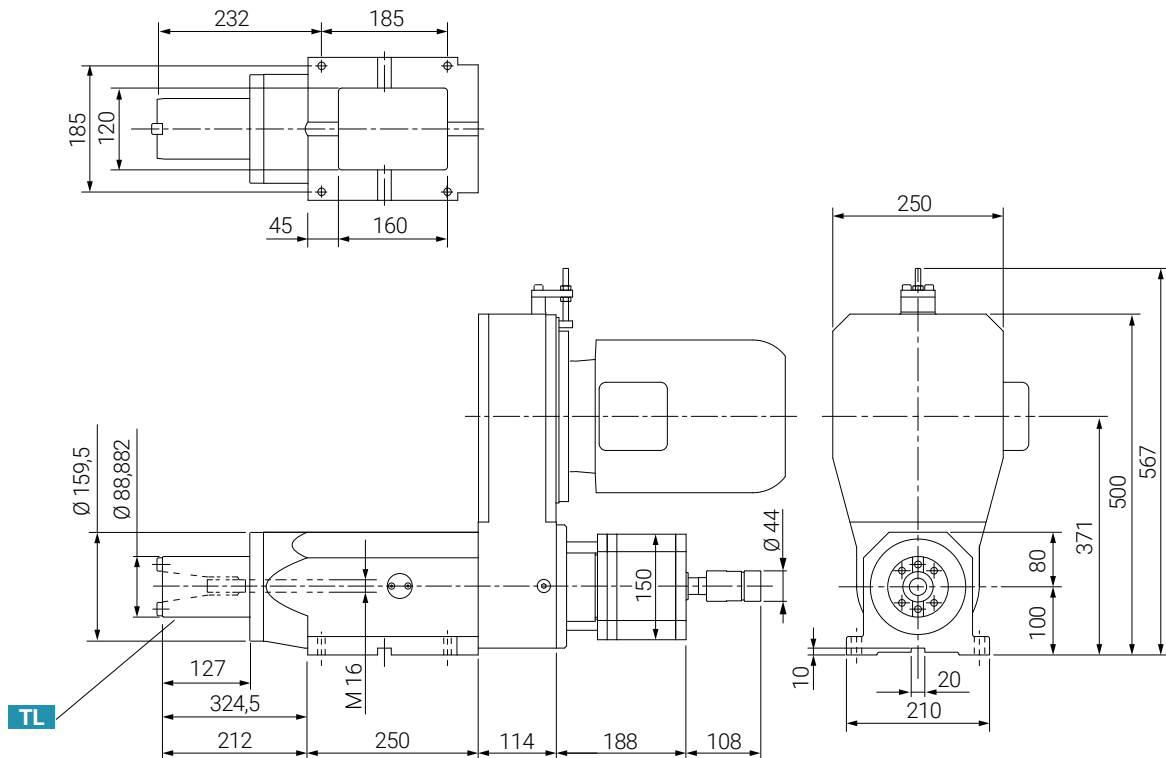



ALLOWED APPLICATIONS MÖGLICHE VERFAHREN

- Drilling - reaming / Bohrfunktion
- Tapping - forming / Gewindeschneiden
- Boring / Aufreibung
- Countersinking / Ausschmiegung

OPTIONAL COMPONENTS OPTIONALE BESTANDTEILE

- Adapter flange for servomotor / Vorbereitung für Servomotor
- Coolant through the spindle / Kühlkanal

Machining spindles Spindeleinheiten

	MAX AXIAL LOAD MAX AXIALE BELASTUNG	25000 N
	WEIGHT GEWICHT	190 Kg

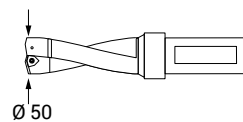

<p>SPINDLE RPM (50HZ) / SPINDELDREHZAHL</p> <table border="1"> <tr><td>A</td><td>160</td><td></td></tr> <tr><td>B</td><td>200</td><td>R6P</td></tr> <tr><td>C</td><td>250</td><td></td></tr> <tr><td>D</td><td>300</td><td></td></tr> <tr><td>E</td><td>400</td><td>R4P</td></tr> <tr><td>F</td><td>500</td><td></td></tr> <tr><td>G</td><td>600</td><td></td></tr> <tr><td>H</td><td>800</td><td>6P</td></tr> <tr><td>I</td><td>1000</td><td></td></tr> <tr><td>J</td><td>1200</td><td></td></tr> <tr><td>K</td><td>1500</td><td></td></tr> <tr><td>L</td><td>1800</td><td>4P</td></tr> <tr><td>M</td><td>2000</td><td></td></tr> <tr><td>N</td><td>2400</td><td></td></tr> <tr><td>O</td><td>3000</td><td>2P</td></tr> <tr><td>P</td><td>3600</td><td></td></tr> </table> <p>CHAIN WITH REDUCER GETRIEBEKETTE</p> <p>TIMING BELT ZAHNRIEMEN</p>	A	160		B	200	R6P	C	250		D	300		E	400	R4P	F	500		G	600		H	800	6P	I	1000		J	1200		K	1500		L	1800	4P	M	2000		N	2400		O	3000	2P	P	3600		<p>DRILLING CAPACITY IN STEEL R=60 BOHRLEISTUNG IN STAHL R=60</p> <p>Ø 50</p>	<p>MOTOR / MOTOR</p> <table border="1"> <tr><td>213</td><td>=</td><td>132</td><td>-</td><td>7.5 kW</td><td>2P</td></tr> <tr><td>412</td><td>=</td><td>132</td><td>-</td><td>7.5 kW</td><td>4P</td></tr> <tr><td>611</td><td>=</td><td>132</td><td>-</td><td>5.5 kW</td><td>6P</td></tr> </table> <p>Max frame 180 / Max Größe 180</p>	213	=	132	-	7.5 kW	2P	412	=	132	-	7.5 kW	4P	611	=	132	-	5.5 kW	6P	<p>TOOLHOLDER WERKZEUGAUFNAHME</p> <p>P = HSK 63 A U = ISO 50 DIN 2079</p>
A	160																																																																				
B	200	R6P																																																																			
C	250																																																																				
D	300																																																																				
E	400	R4P																																																																			
F	500																																																																				
G	600																																																																				
H	800	6P																																																																			
I	1000																																																																				
J	1200																																																																				
K	1500																																																																				
L	1800	4P																																																																			
M	2000																																																																				
N	2400																																																																				
O	3000	2P																																																																			
P	3600																																																																				
213	=	132	-	7.5 kW	2P																																																																
412	=	132	-	7.5 kW	4P																																																																
611	=	132	-	5.5 kW	6P																																																																

DX 58 /.. /.. /.. /..

BEARINGS / LAGERUNG

RC = Taper roller bearings / Kegelrollenlager
CO = Angular contact bearings/ Schrägkugellager

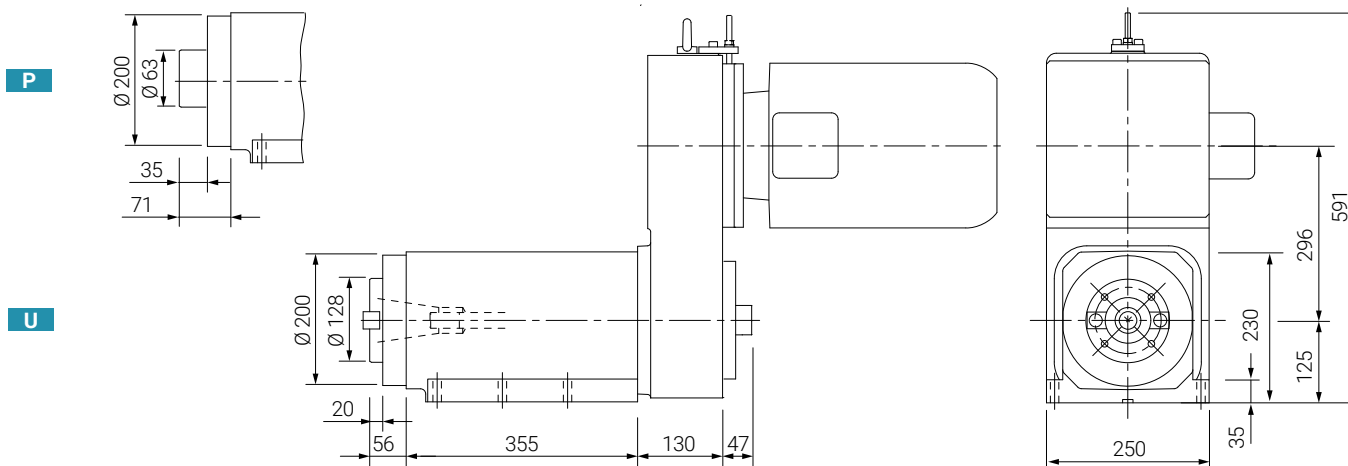
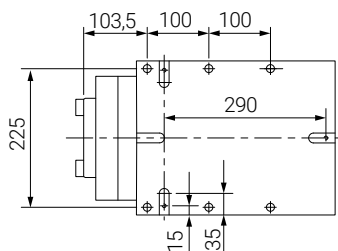



COOLANT THROUGH FACILITY
MIT INNENKÜHLUNG

HYDRAULICALLY UNCLAMPED
HYDRAULISCHE ENTSPANNUNG

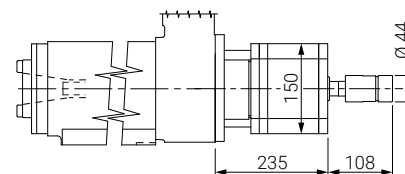
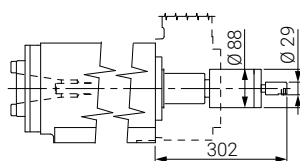
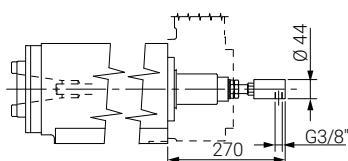
PNEUMATICALLY UNCLAMPED
VORBEREITUNG FÜR INNENKÜHLUNG



Machining spindles Spindeleinheiten

	MAX AXIAL LOAD MAX AXIALE BELASTUNG	40000 N
	WEIGHT GEWICHT	625 Kg

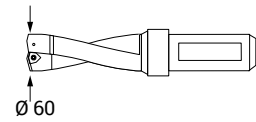

SPINDLE RPM (50HZ) / SPINDELDREHZAHL

G	600	
H	800	6P
I	1000	
J	1200	
K	1500	
L	1800	4P
M	2000	
N	2400	
O	3000	2P
P	3600	

TIMING BELT
ZAHNRIEMEN

DRILLING CAPACITY
IN STEEL R=60
BOHRLEISTUNG
IN STAHL R=60
Ø 60

MOTOR / MOTOR

210	=	180	-	22 kW	2P
411	=	180	-	18 kW	4P
612	=	180	-	15 kW	6P

Max frame 180 / Max Größe 180

TOOLHOLDER
WERKZEUGAUFNAHME

U = ISO 50 DIN 2079

DX 88 /.. /.. /.. /..

BEARINGS / LAGERUNG

RC = Taper roller bearings / Kegelrollenlager
CO = Angular contact bearings / Schrägkugellager

U

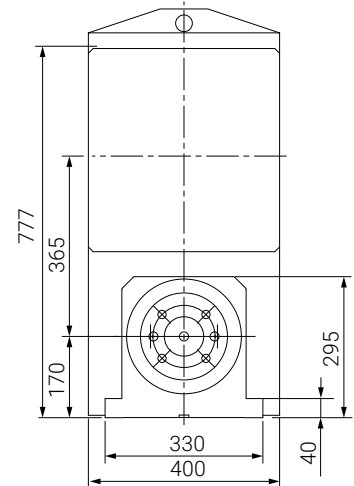
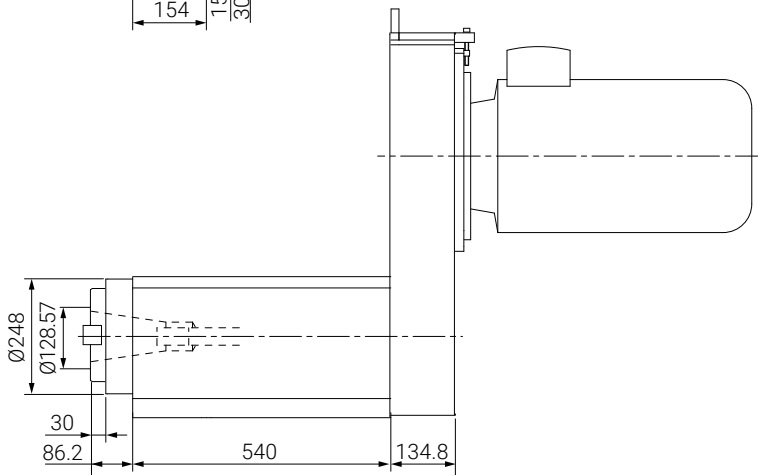
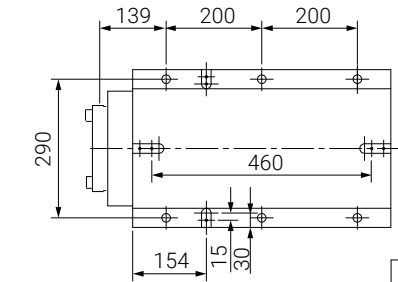

COOLANT THROUGH FACILITY
MIT INNENKÜHLUNG

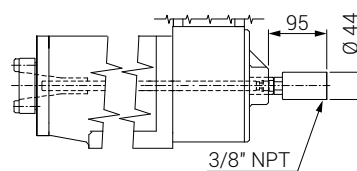



Slide units Schlitteneinheiten

FEATURES

- *Adjustable advance strokes*
- *They are provided with electric limit switches, rear, front position (up to 6 contacts)*
- *Ways forced lubrication*

EIGENSCHAFTEN

- *Regulierbarer Arbeitsgang*
- *Elektrischer Endschalter 3 Spuren (bis zu 6 Spuren erhältlich)*

CNC slide units with ball screw and ball bearing ways CNC Vorschubeinheiten mit Kugelumlaufspindel und linearkugellagern

EX 28 /..

STROKE HUB mm	STRENGHT VORSCHUBKRAFT MAX	WEIGHT GEWICHT Kg	BALL SCREW KUGELUMLAUFSPINDEL	RECOMMENDED FOR EMPFOHLEN FÜR
100	7000 N	30	Ø 20 x 5 mm	DX22 - DX28 (ISO30)
200	7000 N	34	Ø 20 x 5 mm	DX22 - DX28 (ISO30)
300	7000 N	38	Ø 20 x 5 mm	DX22 - DX28 (ISO30)

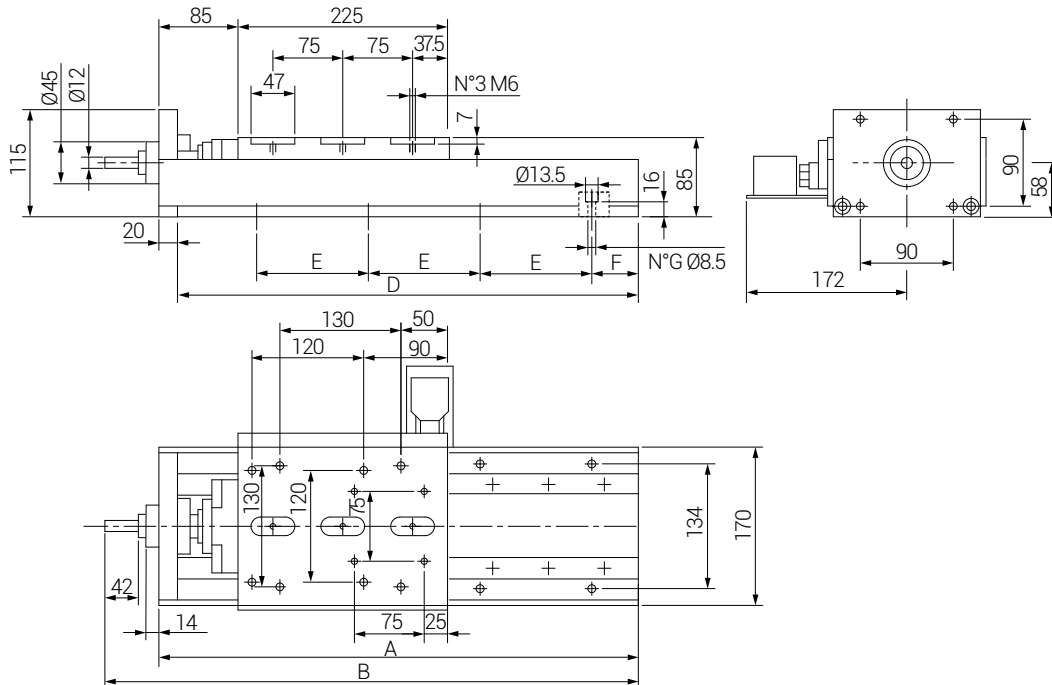

SIZE BAUGRÖÖE	A	B	D	E	F	G
EX28.100	415	482	495	120	70	6
EX28.200	515	582	495	120	50	8
EX28.300	690	757	670	120	35	10

IN LINE FEED MOTOR
VORBEREITUNG DIREKTANTRIEB

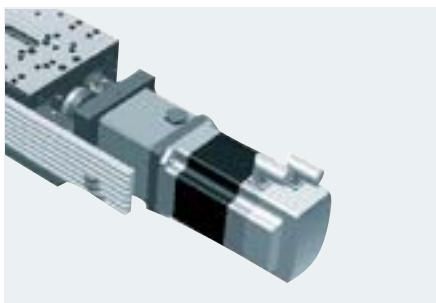

OFF SET MOTOR
VORBEREITUNG RIEMENANTRIEB

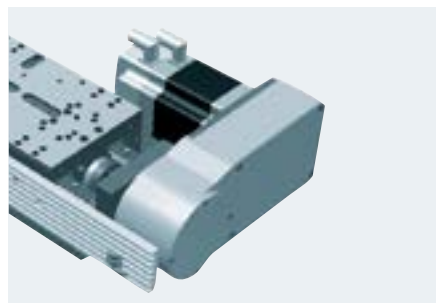

ROLLER CIRCULATING RAILS/PADS
FÜHRUNGEN MIT KUGELUMLAUFWAGEN

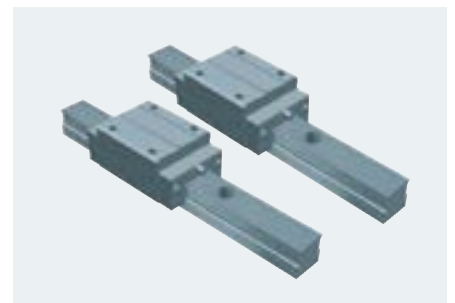

CNC slide units with ball screw and ball bearing ways CNC Vorschubeinheiten mit Kugelumlaufspindel und linearkugellagern

EX 32 /..

STROKE HUB mm	STRENGTH VORSCHUBKRAFT MAX	WEIGHT GEWICHT Kg	BALL SCREW KUGELUMLAUFSPINDEL	RECOMMENDED FOR EMPFOHLEN FÜR
250	9000 N	90	Ø 25 x 5 mm	DX28
400	9000 N	110	Ø 25 x 5 mm	DX28

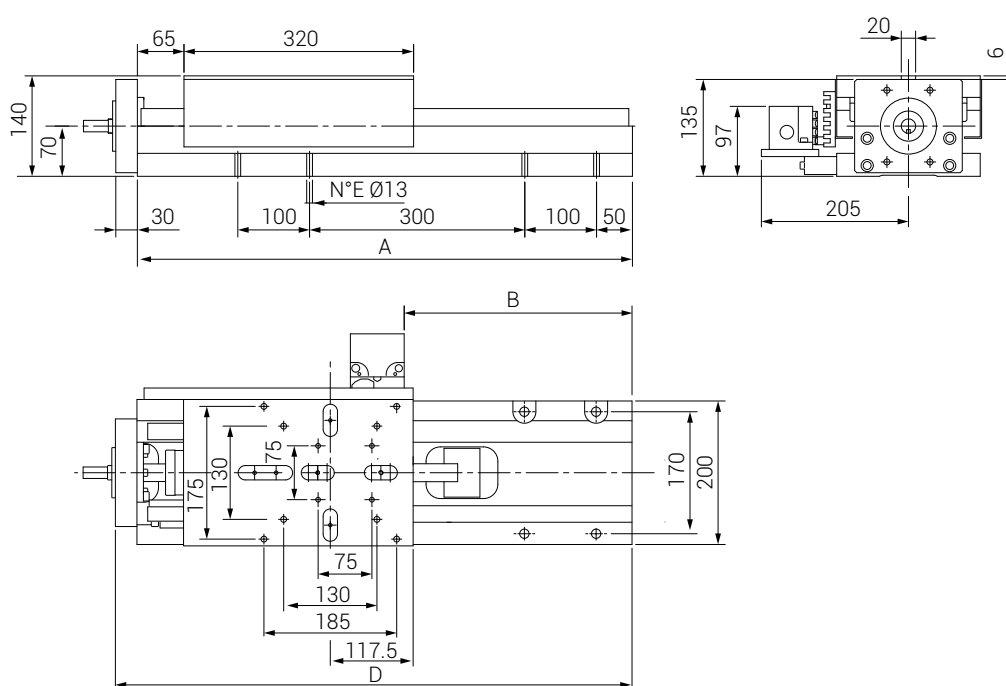

SIZE BAUGRÖßE	A	B	D	E
EX32.250	690	318	720	8
EX32.400	875	490	905	10

**IN LINE FEED MOTOR
VORBEREITUNG DIREKTANTRIEB**

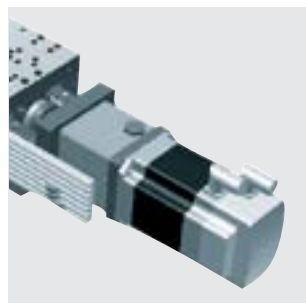

**OFF SET MOTOR
VORBEREITUNG RIEMENANTRIEB**

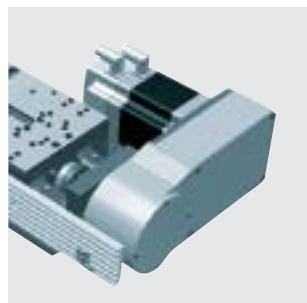

**BELLOW TYPE COVER
FALTENBALGABDECKUNG**

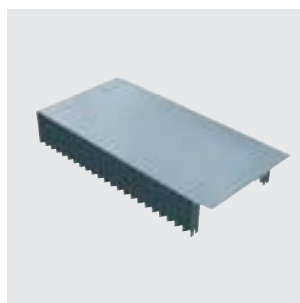

**ROLLER CIRCULATING RAILS/PADS
FÜHRUNGEN MIT KUGELUMLAUFWAGEN**

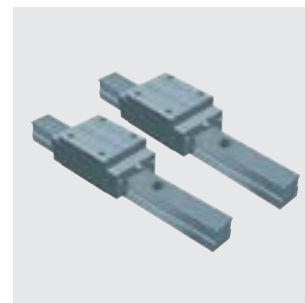

CNC slide units with ball screw and ball bearing ways CNC Vorschubeinheiten mit Kugelumlaufspindel und linearkugellagern

EX 38 /..

STROKE HUB mm	STRENGTH VORSCHUBKRAFT MAX	WEIGHT GEWICHT Kg	BALL SCREW KUGELUMLAUFSPINDEL	RECOMMENDED FOR EMPFOHLEN FÜR
200	21400 N	96	Ø 40 x 5 mm	DX38
300	21400 N	112	Ø 40 x 5 mm	DX38
400	21400 N	128	Ø 40 x 5 mm	DX38
600	21400 N	160	Ø 40 x 5 mm	DX38

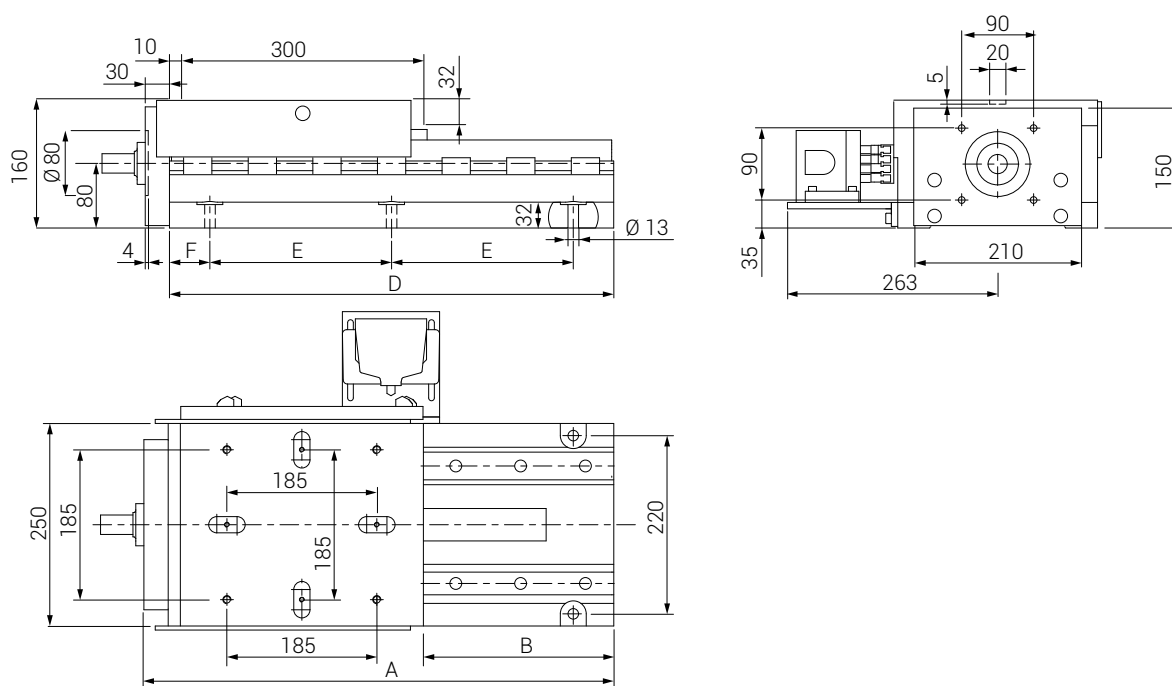

SIZE BAUGRÖÖE	A	B	D	E	F
EX38.200	580	245	550	225	50
EX38.300	700	365	670	280	55
EX38.400	820	485	790	220	60
EX38.600	1065	730	1035	220	60

**IN LINE FEED MOTOR
VORBEREITUNG DIREKTANTRIEB**

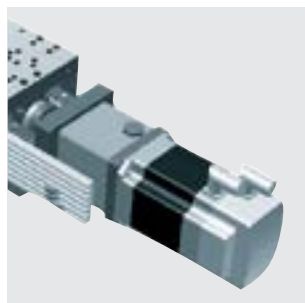

**OFF SET MOTOR
VORBEREITUNG RIEMENANTRIEB**

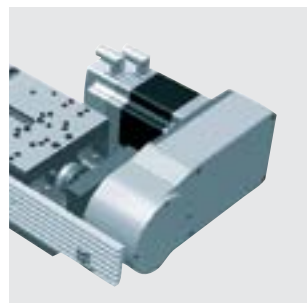

**BELLOW TYPE COVER
FALTENBALGABDECKUNG**

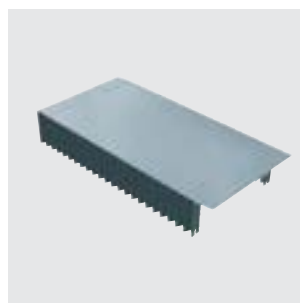

**ROLLER CIRCULATING RAILS/PADS
FÜHRUNGEN MIT KUGELUMLAUFWAGEN**

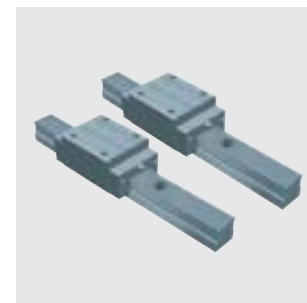

CNC slide units with ball screw and ball bearing ways CNC Vorschubeinheiten mit Kugelumlaufspindel und linearkugellagern

EX 58 /..

STROKE HUB mm	STRENGTH VORSCHUBKRAFT MAX	WEIGHT GEWICHT Kg	BALL SCREW KUGELUMLAUFSPINDEL	RECOMMENDED FOR EMPFOHLEN FÜR
300	21400 N	320	Ø 40 x 5 mm	DX58 - DX88

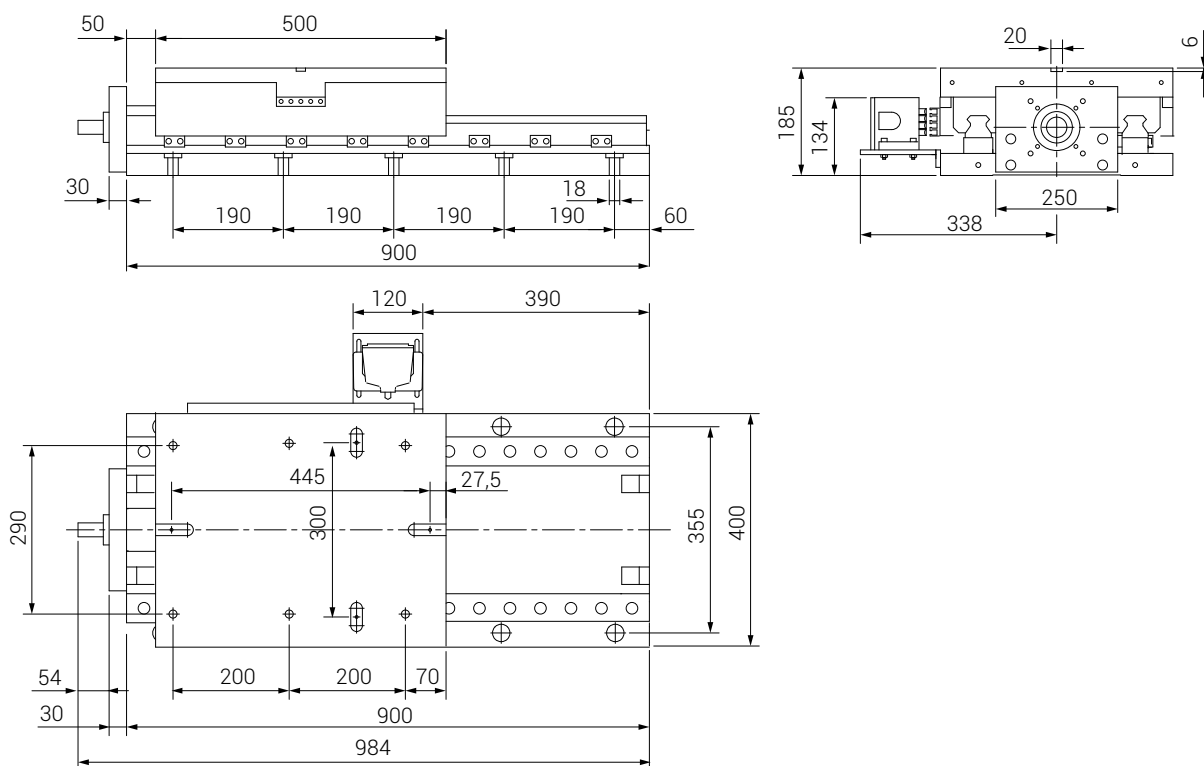

**IN LINE FEED MOTOR
VORBEREITUNG DIREKTANTRIEB**

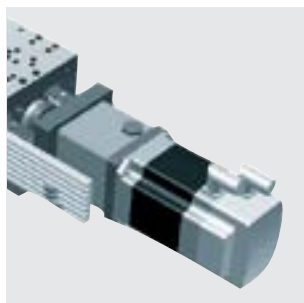

**OFF SET MOTOR
VORBEREITUNG RIEMENANTRIEB**

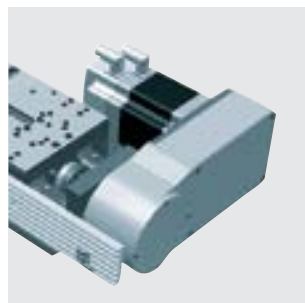

**BELLOW TYPE COVER
FALTENBALGABDECKUNG**

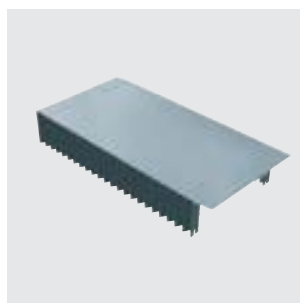

**ROLLER CIRCULATING RAILS/PADS
FÜHRUNGEN MIT KUGELUMLAUFWAGEN**

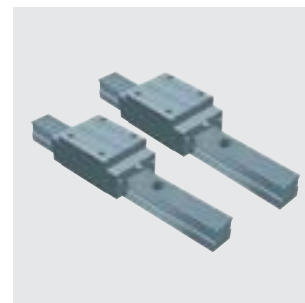

Hydraulic slide units with ball bearing ways Hydraulischer Vorhubschlitten und linearkugellagern

HX 38 /..

STROKE HUB mm	STRENGHT VORSCHUBKRAFT 35 bar	WEIGHT GEWICHT Kg	HYDRAULIC CYLINDER HYDRAUL ZYLINDER	RECOMMENDED FOR EMPFOHLEN FÜR
200	15500 N	92	Ø 63	DX38
300	15500 N	108	Ø 63	DX38

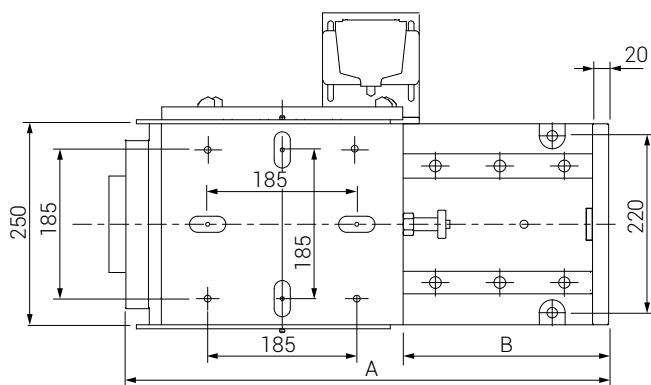
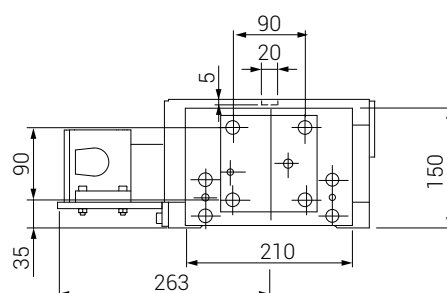
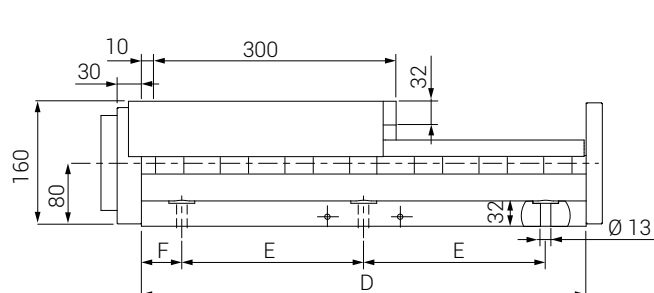

SIZE BAUGRÖßE	A	B	D	E	F
HX38.200	600	265	550	260	50
HX38.300	720	385	670	320	55

BELLOW TYPE COVER
FALTENBALGABDECKUNG

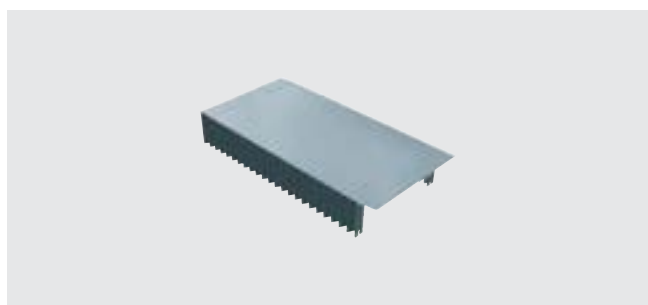

ROLLER CIRCULATING RAILS/PADS
FÜHRUNGEN MIT KUGELUMLAUFWAGEN





Rotary indexing tables Rundschanttische

FEATURES

- *Installation with horizontal and vertical axis*
- *Available with two indexing systems: two taper pins for accuracy ± 10 sec. Or Hirth face gear for accuracy ± 5 sec.*
- *Only one Pneumatic supply*

EIGENSCHAFTEN

- Horizontal und vertikal einsetzbar
- Die Winkelteilgenauigkeit ist durch zwei Systeme gewährleistet:
Teilung mit 2 Sperrbolzen (Genauigkeit ± 10 sec)
auf Wunsch mit (Hirthverzahnung ± 5 sec)
- Pneumatischer Druckluftanschluß

Rotary indexing tables Rundschalttische

 WEIGHT
GEWICHT

38 Kg

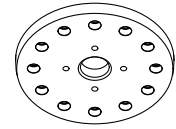

HORIZONTAL AXIS
HORIZONTALACHSE

P = PNEUMATIC /
inside solenoid valves
PNEUMATIK /
interne Magnetventile

INDEXING WITH 2 PINS INDEX SYSTEM
TEILUNGEN MIT 2 SPERRBOLZEN
D24 = 3.4.6.8.12.24

TABLE WITH T SLOTS
TELLER MIT T - NUTEN

TA 220 /P /D24 /T

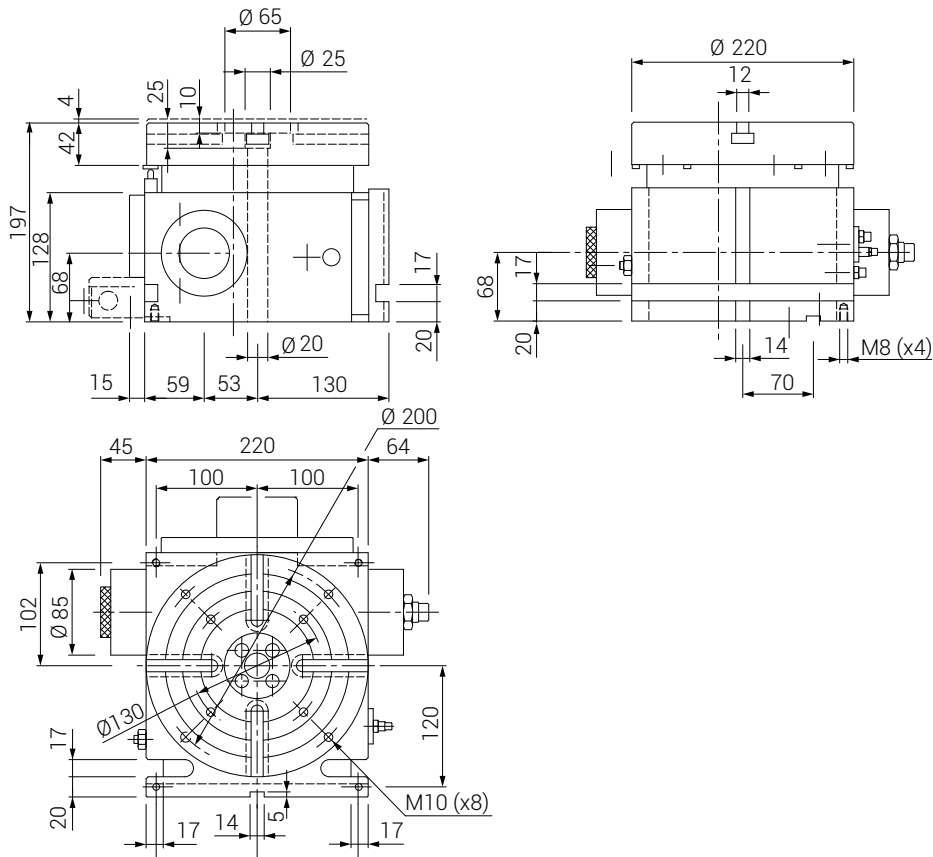

TECHNICAL DATA / TECHNISCHE DATEN

Indexing accuracy Teilgenauigkeit	On plate diameter Bei Tischdurchmesser	Table flatness Planlauf	Center accuracy Zentriergenauigkeit	Operating pressure Betriebsdruck	Clamping force Spannkraft	Rotation torque Drehmoment
+/- 10 Arc sec	+/- 0,005 mm	0,02 mm	0,02 mm	6 - 8 Bar	4500 N	25 Nm

WORKING FORCES / BEARBEITUNGSKRAFT

Axial working force Max. Axialdruck	Max radial force Max. Tangentialkraft	Max tilting moment Kippmoment
15000 N	250 Nm	350 Nm
		

MAX CARRIED LOAD / MAX. TRANSPORTLAST

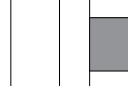
With horizontal axis Horizontalachse	Max inertia moment Max. Trägheitsmoment
40 Kg 80 Nm	7,5 kgm ²
	

Rotary indexing tables Rundschalttische

 WEIGHT
GEWICHT

38 Kg

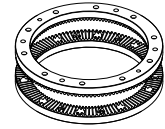

HORIZONTAL AXIS
HORIZONTALACHSE

P = PNEUMATIC /
inside solenoid valves
PNEUMATIK /
interne Magnetventile

TEILUNGEN MIT HIRTH PLANVERZÄHUN
INDEXING WITH HIRTH GEARS
Z72 = 3.4.6.8.12.24

TABLE WITH T SLOTS
Teller mit T-Nuten

TA 220 /P /Z72 /T

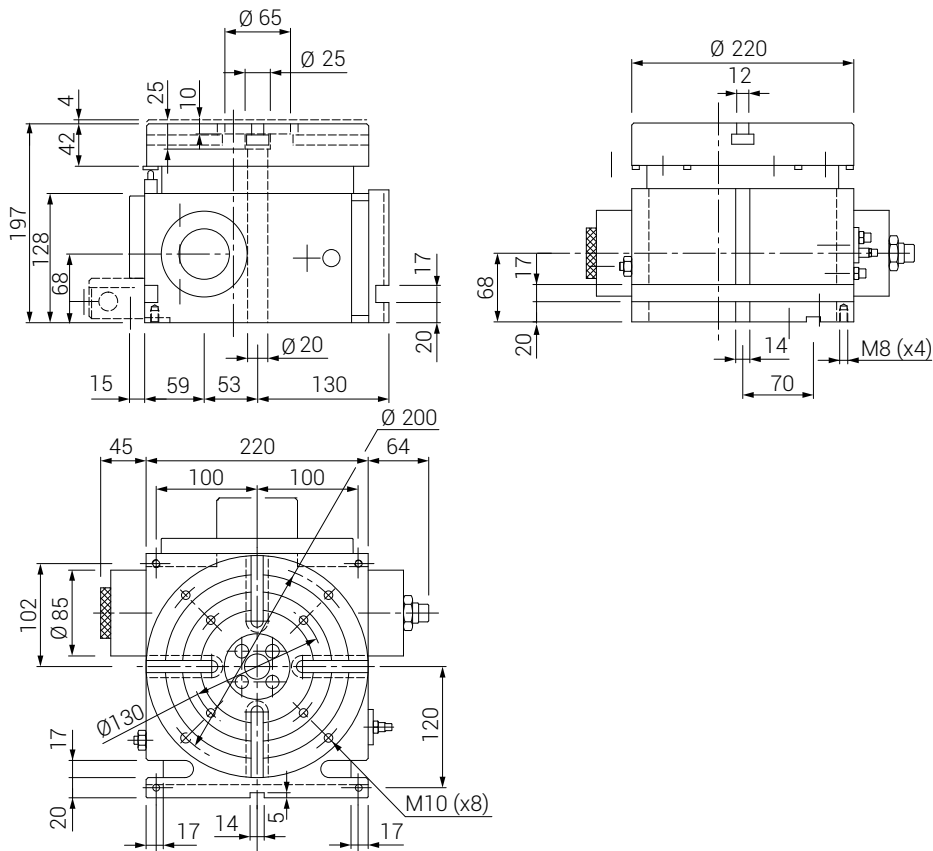

TECHNICAL DATA / TECHNISCHE DATEN

Indexing accuracy Teilgenauigkeit	On plate diameter Bei Tischdurchmesser	Table flatness Planlauf	Center accuracy Zentriergenauigkeit	Operating pressure Betriebsdruck	Clamping force Spannkraft	Rotation torque Drehmoment
+/- 5 Arc sec	+/- 0,0025 mm	0,02 mm	0,02 mm	6 - 8 Bar	4500 N	25 Nm

WORKING FORCES / BEARBEITUNGSKRAFT

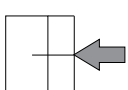
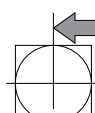
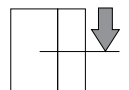
Axial working force Max. Axialdruck	Max radial force Max. Tangentialkraft	Max tilting moment Kippmoment
15000 N	500 Nm	350 Nm
		

MAX CARRIED LOAD / MAX. TRANSPORTLAST

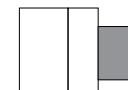
With horizontal axis Horizontalachse	Max inertia moment Max. Trägheitsmoment
40 Kg 80 Nm	7,5 kgm ²
	

Rotary indexing tables Rundschalttische

 WEIGHT
GEWICHT

85 Kg

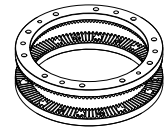

VERTICAL AXIS
VERTIKALACHSE

P = PNEUMATIC /
inside solenoid valves
PNEUMATIK /
interne Magnetventile

TEILUNGEN MIT HIRTH PLANVERZÄHUN
INDEXING WITH HIRTH GEARS

Z72=3.4.6.8.12.24

TA 326 /P /Z72

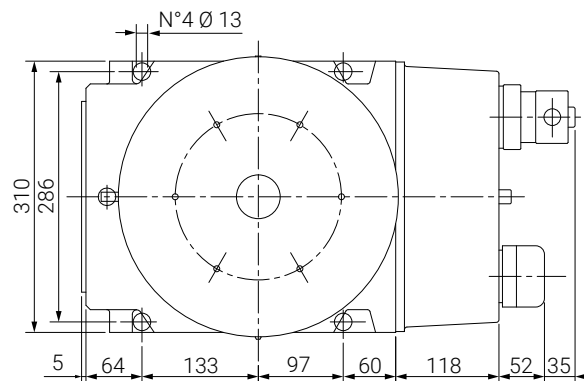
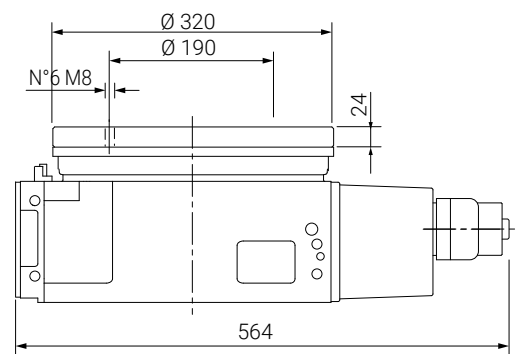
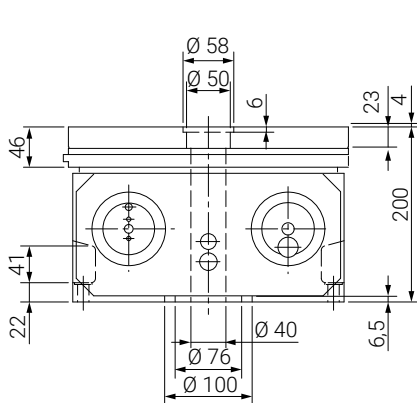

TECHNICAL DATA / TECHNISCHE DATEN

Indexing accuracy Teilgenauigkeit	On plate diameter Bei Tischdurchmesser	Table flatness Planlauf	Center accuracy Zentriergenauigkeit	Operating pressure Betriebsdruck	Clamping force Spannkraft	Rotation torque Drehmoment
+/- 5 Arc sec	+/- 0,004 mm	0,02 mm	0,02 mm	6 Bar	15800 N	100 Nm

WORKING FORCES / BEARBEITUNGSKRAFT

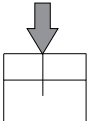
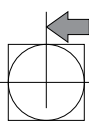
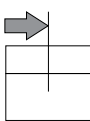
Axial working force Max. Axialdruck	Max radial force Max. Tangentialkraft	Max tilting moment Kippmoment
30000 N	950 Nm	600 Nm
		

MAX CARRIED LOAD / MAX. TRANSPORTLAST

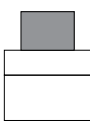
With vertical axis Vertikalachse	Max inertia moment Max. Trägheitsmoment
250 Kg	20 kgm ²
	

Rotary indexing tables Rundschalttische

 WEIGHT
GEWICHT

280 Kg

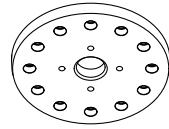

VERTICAL AXIS
VERTIKALACHSE

P = PNEUMATIC /
inside solenoid valves
PNEUMATIK /
interne Magnetventile

INDEXING WITH 2 PINS INDEX SYSTEM
TEILUNGEN MIT 2 SPERRBOLZEN
Z72 = 3.4.6.8.12.24

TA 600 /P /D24

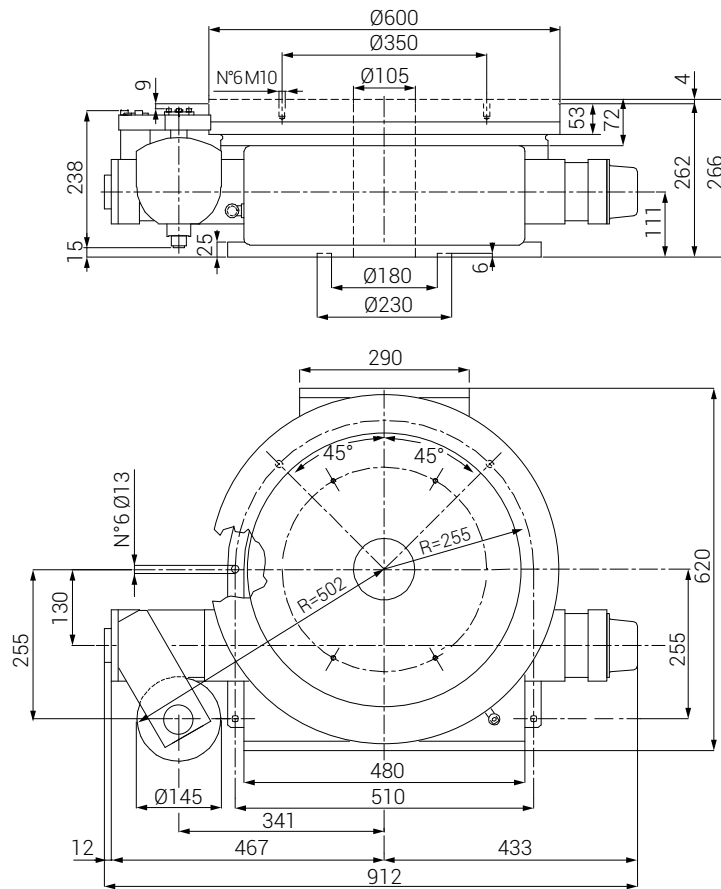

TECHNICAL DATA / TECHNISCHEN DATEN

Indexing accuracy Teilgenauigkeit	On plate diameter Bei Tischdurchmesser	Table flatness Planlauf	Center accuracy Zentriergenauigkeit	Operating pressure Betriebsdruck	Clamping force Spannkraft	Rotation torque Drehmoment
+/- 10 Arc sec	+/- 0,015 mm	0,03 mm	0,03 mm	6 Bar	35400 N	350 Nm

WORKING FORCES / BEARBEITUNGSKRAFT

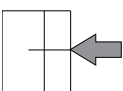
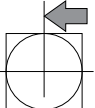
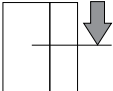
Axial working force Max. Axialdruck	Max radial force Max. Tangentialkraft	Max tilting moment Kippmoment
30 kN	2000 Nm	8000 Nm
		

MAX CARRIED LOAD / MAX. TRANSPORTLAST

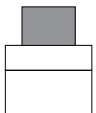
With vertical axis Vertikalachse	Max inertia moment Max. Trägheitsmoment
900 Kg	100 kgm ²
	

Rotary indexing tables Rundschalttische

 WEIGHT
GEWICHT

750Kg

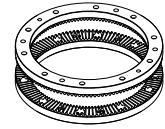

VERTICAL AXIS
VERTIKALACHSE

TEILUNGEN MIT HIRTH PLANVERZÄHUN
INDEXING WITH HIRTH GEARS

Z120

TA 700 /Z120

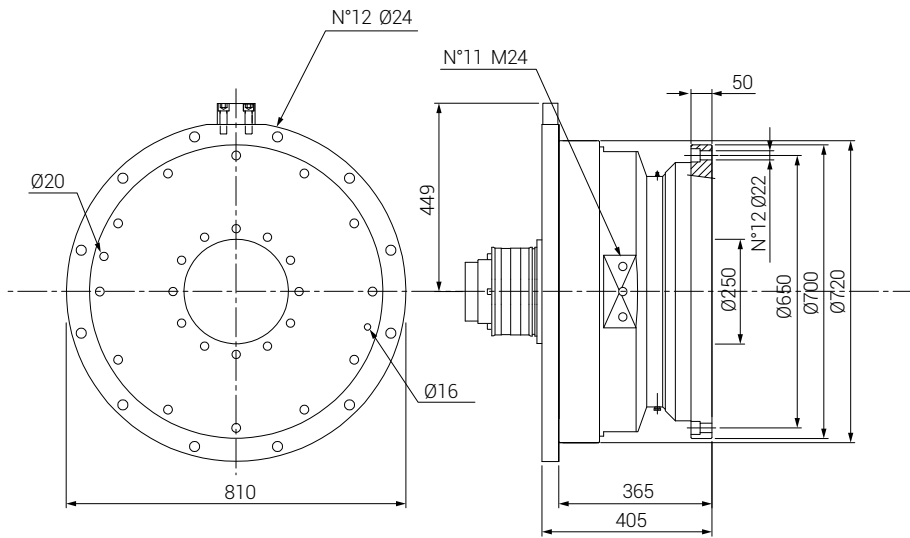

TECHNICAL DATA / TECHNISCHEN DATEN

Indexing accuracy Teilgenauigkeit	On plate diameter Bei Tischdurchmesser	Table flatness Planlauf	Center accuracy Zentriergenauigkeit	Hydraulic plate unclamp Hydraulische Spannung	Clamping force Spannkraft	Rotation torque Drehmoment
+/- 5 Arc sec	+/- 0,008 mm	0,02 mm	0,03 mm	20 Bar	70000 N	1600 Nm

WORKING FORCES / BEARBEITUNGSKRAFT

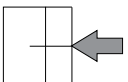
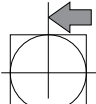
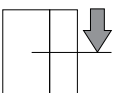
Axial working force Max. Axialdruck	Max radial force Max. Tangentialkraft	Max tilting moment Kippmoment
105 kN	11000 Nm	18000 Nm
		

MAX CARRIED LOAD / MAX. TRANSPORTLAST

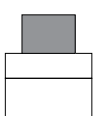
With vertical axis Vertikalachse	Max inertia moment Max. Trägheitsmoment
2000 Kg	600 kgm ²
	



Accessories Zubehör

FEATURES

- *Supports and brackets for fast assembly of the quill units*
 - *Linear tables*
 - *Right angle tables*

EIGENSCHAFTEN

- **Standard-Zubehör für die schnelle Montage der Pinoleneinheiten**
 - **Justier - schlitten**
 - **Kreuz schlitten**

Supports and brackets Standardzubehör

BASE BLOCKHALTERUNG

	A	B	C	D	E	F	G	H	I
F60	60	80	60	90	120	70	100	9	40
F85	85	100	85	125	150	100	125	11	55

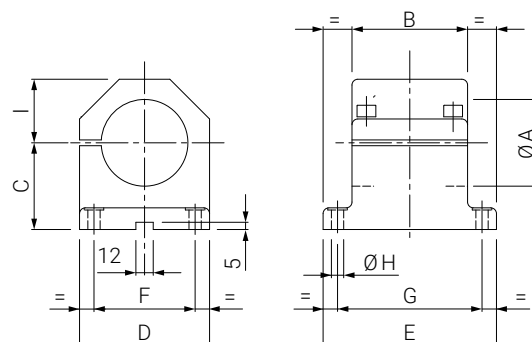

PARALLEL CLAMP PARALLELHALTERUNG

	A	B	C	D	E
EBPE85.60	60	85	200	110	55
EBPE85.85	85	85	200	110	55

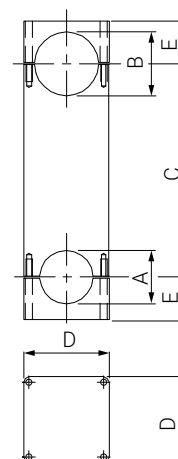

CROSS BRACKET KREUZHALTERUNG

	A	B	C	D	E
EBIE85.60	60	85	200	110	55
EBIE85.85	85	85	200	110	55

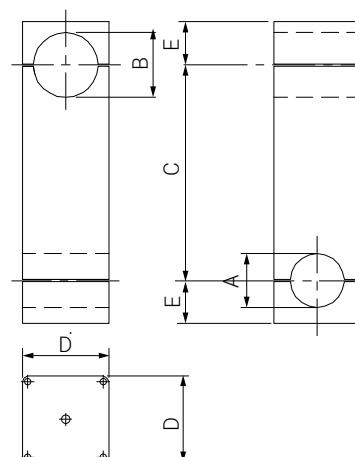

Supports and brackets Standardzubehör

BASE CLAMP FUSSHALTERUNG

	A	B	C	D	E	F	G	H	I	L
EAE85	85	200	125	140	190	180	43	13	70	95

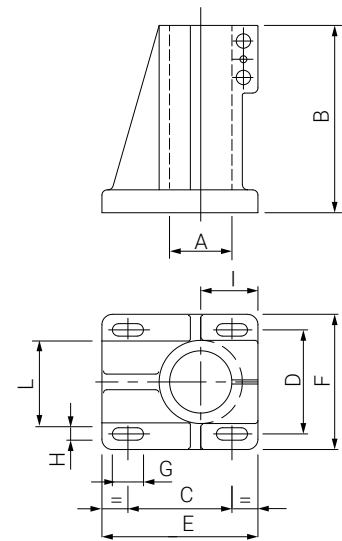

ADJUSTABLE BASE JUSTIER-HALTERUNG

	A	B	D	F	G	H	I	L	M
EGE85	85	225	25	300	260	180	80	30	13

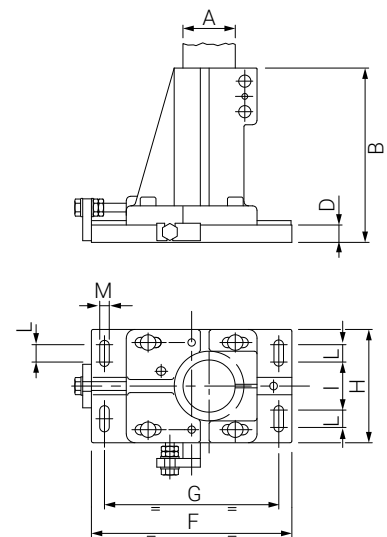

ADJUSTABLE COLUMN VERSTELLUNG RUNDFUHRUNG

	A	B	C	D	E	I
EHE85	85	400 - 500 - 600	165	N°10 - M10x25	80	110

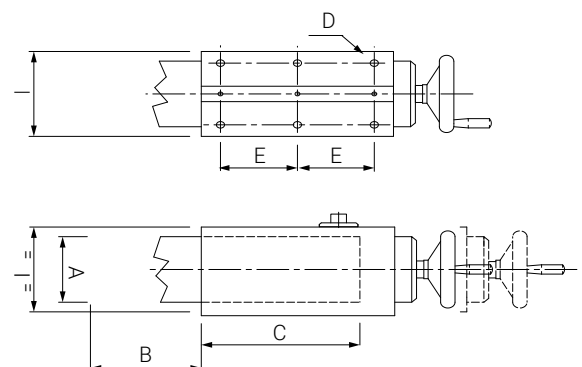

Supports and brackets Standardzubehör

COLUMN SAÜLE

	A	B	L						
EDE85	85	65	500	600	700	800	900	1000	

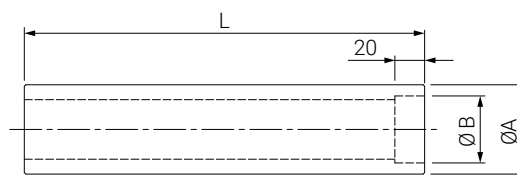

COLUMN SAÜLE

	A	B		
EDEH85	85	400	500	600

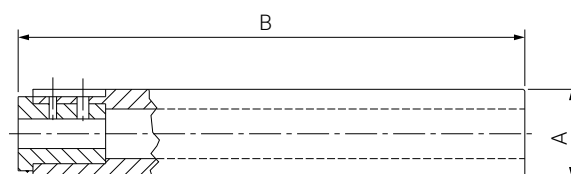

PARALLEL BRACKET FOR COLUMN PARALLELHALTERUNG FÜR SAÜLE

	A	B	C	D	E	F	G	H	I	L
EIPE60	60	80	100	60	100	140	110	155	5	110
EIPE85	85	80	100	60	100	140	110	155	5	110

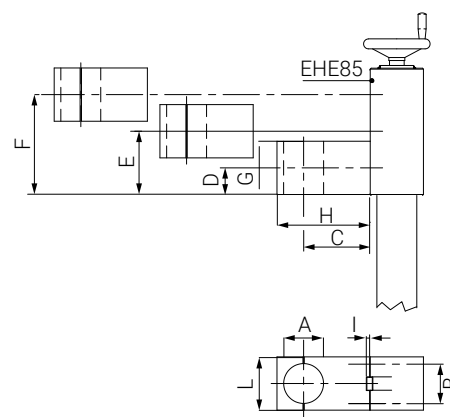

CROSS BRACKET FOR COLUMN KREUZHALTERUNG FÜR SAÜLE

	A	B	C	D	E	F	G	H	I	L
ELIE60	60	80	100	60	100	140	110	155	5	110
ELIE85	85	80	100	60	100	140	110	155	5	110

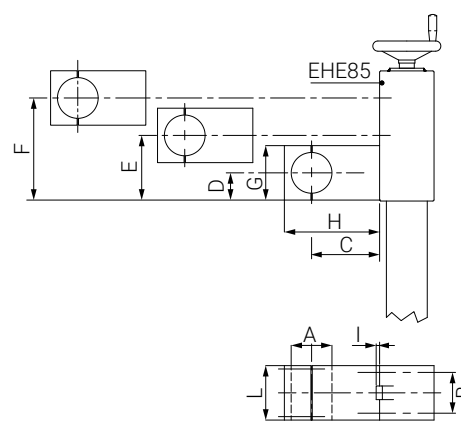

Supports and brackets Standardzubehör

CAP SAÜLENEINSATZ

	A	B	C	D
EEE85	65	84,5	5	10

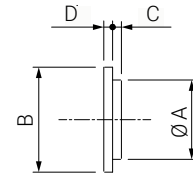

STOP COLLAR KLEMMRING

	A	B	C
EME85	85	124	20

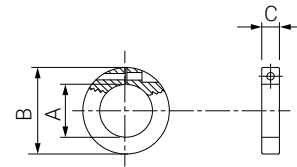

ADJUSTABLE SUPPORT JUSTIERSÄULE

	A	B	C	D	E	F	G	H	I
EJE85	130	110	80	60	20	5	4	50	200

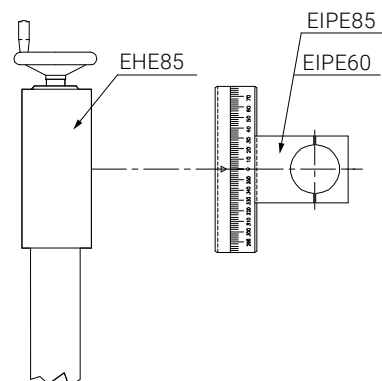
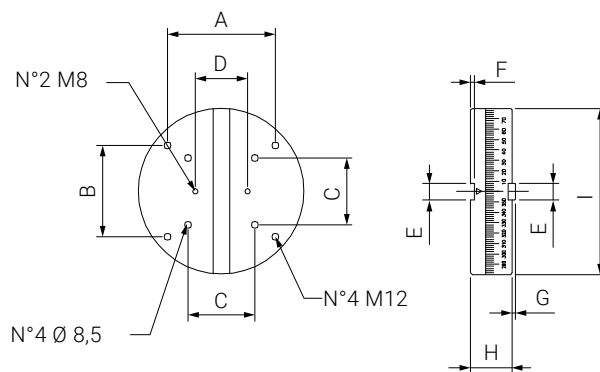

Supports and brackets Standardzubehör

LINEAR TABLES JUSTIER - SCHLITTEN

	A	B	D	J	K	L	M	P
G.TL200	490	300	81	40	16.5	77	33	155
G.TL300	570	380	81	40	43	77	40	165
G.TL400	770	500	105	58.5	52	110	51	202
G.TL500	870	600	110	60	76	110	80	250
G.TL600	1020	752	116	59	76	110	180	300

	Q	R	S	T	U	V	Kg	mm
G.TL200	40	10H7	220	13	178	210	23	210
G.TL300	41	10H7	280	13	196	230	35	285
G.TL400	53	10H7	375	16	238	280	66	410
G.TL500	64	14H7	452	16	294	340	93	500
G.TL600	95	14H7	560	16	348	400	162	600

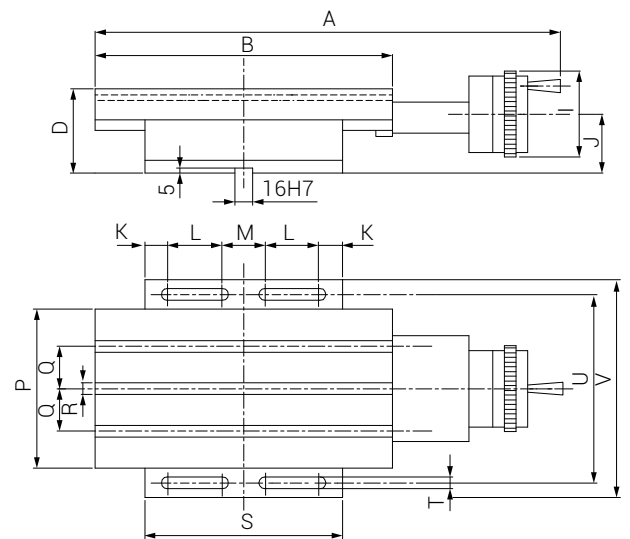

RIGHT ANGLE TABLES KREUZ SCHLITTEN

	A	B	D	G	H	I	J	K	M
G.TO200	490	300	100	175	60	21,5	210	453	155
G.TO300	570	380	105	184	62,5	23	220	529	165
G.TO400	770	500	128	240	82,5	27	280	668	202
G.TO500	870	600	128	294	77	25	338	769	250
G.TO600	1020	752	143	360	90	36	410	900	300

	M	N	O	P	Q	R	Kg	mm X	mm Y
G.TO200	155	40	10H7	13	76	34	46	220	235
G.TO300	165	41	10H7	13	77	58.5	70	270	315
G.TO400	202	53	10H7	16	110	56	130	310	410
G.TO500	250	64	14H7	16	110	36	180	400	500
G.TO600	300	95	14H7	16	85	72.5	360	500	610

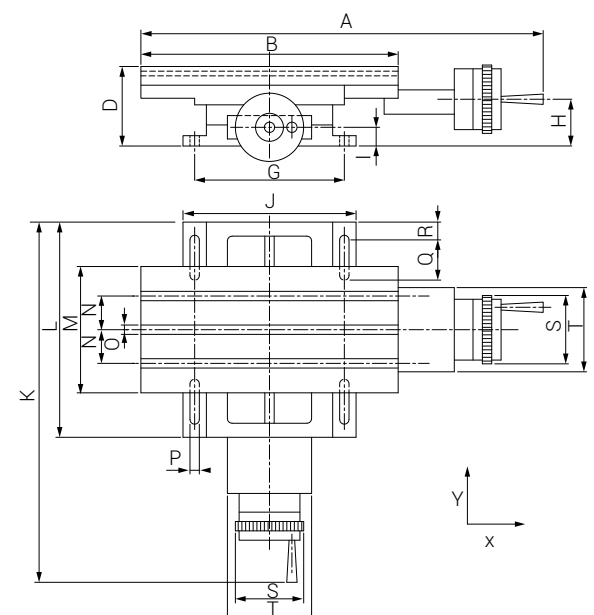



Multiple heads Mehrspindelköpfe

FEATURES

- *Heads with adjustable distance*
- *Fixed centres heads*

EIGENSCHAFTEN

- Verstellbare Mehrspindelköpfe
- Feste Bohrköpfe

Multiple heads Mehrspindelköpfe

HEADS WITH ADJUSTABLE DISTANCE VERSTELLBARE MEHRSPINDELKÖPFE

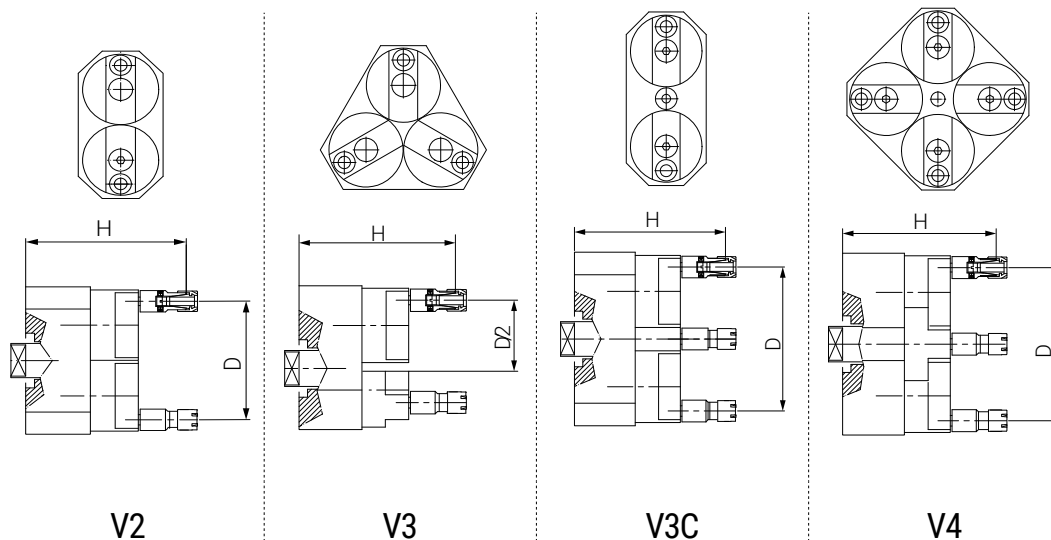

		V2		V3		V3C		V4	
		D	H	D	H	D	H	D	H
ER8	Ø5 / M4	13,5 - 69,5	93	19,9 - 75,9	93	27,83	93	30,7 - 86,7	93
ER11	Ø7 / M6	18 - 130	136	29,5 - 141,5	136	36 - 148	136	49 - 161	136
ER16	Ø10 / M8	24 - 124	153	35,5 - 135,5	153	48,5 - 148,5	153	55 - 155	153
ER20	Ø13 / M10	29 - 135	157	42 - 148	157	63 - 169	157	63 - 169	157
ER25	Ø14 / M12	37 - 165		53 - 181		79 - 207		79 - 207	

FEATURES

Flange, joint, and puller for the assembly of the multiple head on the unit are included.

EIGENSCHAFTEN

Inklusive Flansch, Mitnehmer und Aufnahmeadapter für die Montage der Mehrspindelköpfe.



Multiple heads Mehrspindelköpfe

V.F - FIXED CENTRES HEADS
V.F - FESTE BOHRKÖPFE

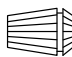
Type Typ	Steel 500 N/mm ² Steel 500 N/mm ²		Min. centres distance Min. Achsabstand	L	Ø A	B	D	 Type Typ	Capacity Spannbereich
	Ø	M							
V.F*.1502.P	2	2	9	125		38	24	80-1502	0,5 ÷ 3
V.F*.1502.P	3	3	10	125		38	24	80-1502	0,5 ÷ 3
V.F*.08.P	5	5	12	120		33	24	ER 8	0,5 ÷ 5
V.F*.08.P	6	5	14	120		33	24	ER 8	0,5 ÷ 5
V.F*.11.P	7	6	16	129		42	29	ER 11	0,5 ÷ 7
V.F*.16.P	10	8	22	143		56	39	ER 16	0,5 ÷ 10
V.F*.08.D	5	5	15	138	8	51			
V.F*.10.D	7	6	18	152	10	65			
V.F*.12.D	10	8	22	156	12	69			
V.F*.03W	3	3	10	115	3	26	14		
V.F*.05W	5	5	12	119	5-6-7	32	20		
V.F*.06W	6	5	14	119	5-6-7	32	20		
V.F*.07W	7	6	17	125	6-7-8	38	22		
V.F*.10W	10	8	22	135	8-9-10	48	26		

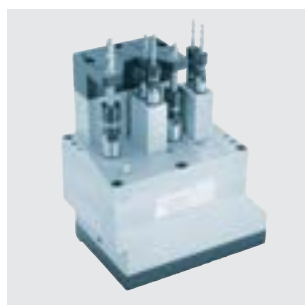
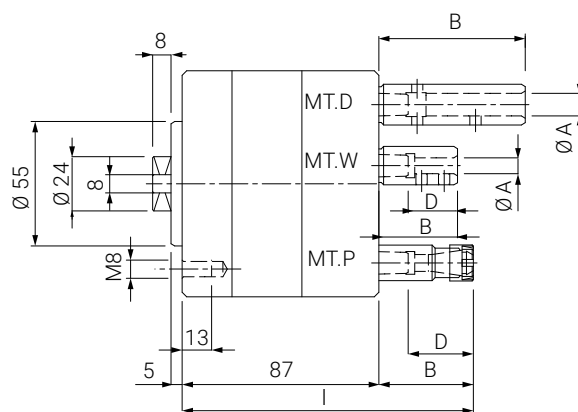

Multiple heads Mehrspindelköpfe

V.FP - FIXED CENTRES HEADS FOR HEAVY DUTY
V.FP - FESTE BOHRKÖPFE FÜR SCHWERES ZERSPANEN

Type Typ	Steel 500 N/mm ² Steel 500 N/mm ²		Min. centres distance Min. Achsabstand	Ø A	Ø B	Ø C	L1	L2	L3	Type Typ	Capacity Spannbereich
	Ø	M									
V.FP1.*.11.P	5	5	16	16	16	22	156	42	10	ER 11	0,5 ÷ 7
V.FP2.*.11.P	7	7	20	18	20	26	153	39	9	ER 11	0,5 ÷ 7
V.FP1.*.16.P	9	8	24	22	24	30	163	49	9	ER 16	0,5 ÷ 10
V.FP2.*.16.P	10	8	27	24	27	33	167	48	8	ER 16	0,5 ÷ 10
V.FP1.*.20.P	12	10	31	28	31	37	183	64	19	ER 20	1 ÷ 13
V.FP2.*.20.P	12	10	34	28	34	40	183	64	19	ER 20	1 ÷ 13
V.FP1.*.25.P	14	12	38	34	38	44	190	71	22	ER 25	1 ÷ 16
V.FP2.*.25.P	18	14	46	42	46	53	186,5	62,5	22	ER 25	1 ÷ 16
V.FP1.*.32.P	20	16	50	50	50	56	196,5	72,5	26	ER 32	1 ÷ 20
V.FP2.*.32.P	20	16	52	47	52	69,5	182	58	23	ER 25	1 ÷ 16

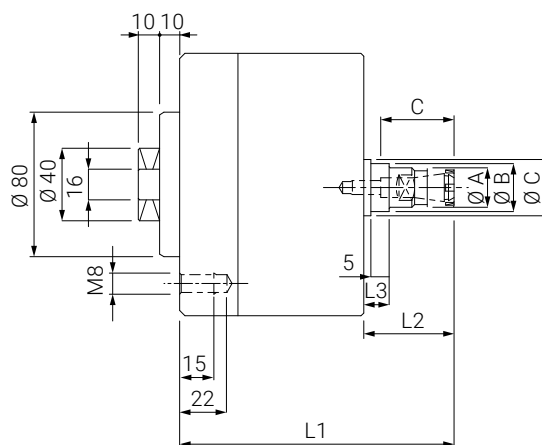

DIMENSIONS AND PROPERTIES ARE NOT BINDING AND MAY CHANGE WITHOUT NOTICE. MAX. LOAD CAPACITIES ARE ONLY INDICATIVE. THEY MUST THEREFORE BE ALWAYS RELATED TO THE REAL CONDITIONS OF WORK. DRILLMATIC WILL NOT BE RESPONSIBLE FOR ANY DAMAGE CAUSED BY THE INADEQUATE USE OF THE DATA.

ABMESSUNGEN UND EIGENSCHAFTEN SIND NICHT VERBINDLICH UND KÖNNEN SICH DADURCH OHNE VORANKÜNDIGUNG ÄNDERN. DIE WERTE BZGL. DER MAXIMALEN BELASTUNGSGRENZEN DER PRODUKTE DER PRODUKTE SIND RICHTWERTE. DIESE WERTE SOLLTEN MIT DEN TATSÄCHLICHEN ANWENDUNGSBEDINGUNGEN DER PRODUKTE JEDESMAL VERGlichen WERDEN. ALLERDINGS ÜBERNIMMT DRILLMATIC KEINE HAFTUNG FÜR VERLUSTE UND SCHÄDEN DURCH UNSACHGEMÄSSE VERWENDUNG.

GRAPHIC DESIGN: NADIR SELVA
PRINT: TIPOGRAFIA ZAMPIGHI

FIRST JUNE 2020
ERSTAUSGABE JUNI 2020





DRILL MATIC

by

EUROMAGROUP

MADE IN ITALY

Via Cavour, 5 - 40012 Calderara di Reno (BO) Italy
Tel.: +39051755423 info@euromagroup.com